

REV.	ECN.NO.	DATE
A	RELEASED	02/19/04
C	Add Color	04/15/05
D	Add Dimension Modify Plating Modify Housing UL	07/15-'19

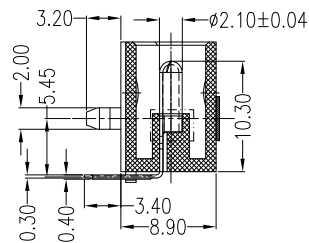

SECT A-A

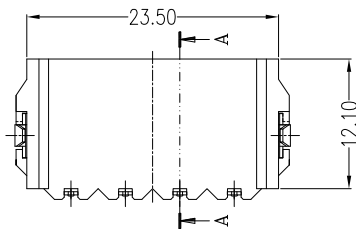
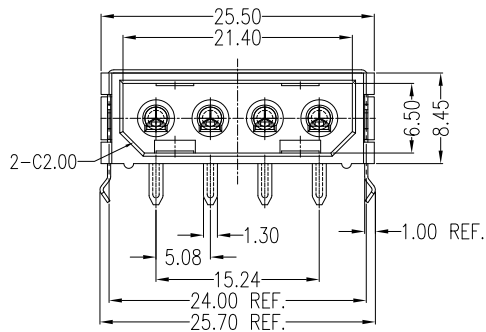
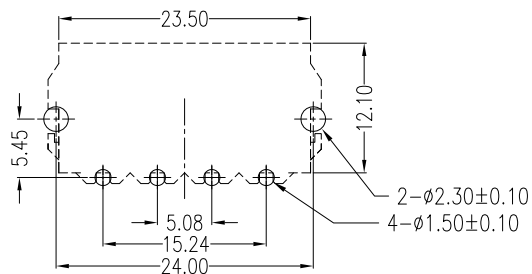
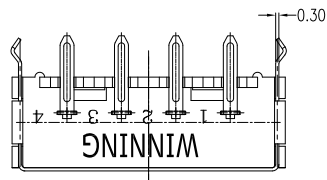

P.C.B Layout
TOP VIEW

NOTES:

***Material**

Housing:Nylon66, UL 94V-2 rated;

Color:Transparent & Black

Contacts: Brass.

Plating: Sn(100u"min) Plating over all, Ni(40u"min) underplating over all.

***ELECTRICAL SPECIFICATION**

Operation Voltage:250V AC max.

Current Rating: 5 Ampere per contact

Contact Resistance:10 Milliohms max.

Insulation Resistance:1000 Megohms min.

Dielectric Withstanding Voltage:1500V AC

***ENVIRONMENTAL**

Operating Temperature: -40°C to +80°C

***HOW TO ORDER**

WPOD-04T6NAB W

- K:Kink Blank:No Kink
- W:Winning Mark Blank:No Mark
- U:Lead Free
- B:Brass
- 1:BLACK A:Transparent
- N:Nylon66
- 6:Right Angle(Copper Piece)
- T:Tin
- Number of Contacts
- Serial NO.

REV	1.Add Dimension: $\phi 2.10 \pm 0.04$, 2.Modify Plating 3.Modify Housing UL			Drawing By	Date	WIN WIN PRECISION IND. CO., LTD.				
Units	mm	Scale	1:1	LZX	07/17-'19	TEL: 886-2-22994155 FAX: 886-2-22994157				
Tolerance Unless Otherwise Specified				Reviewed By	Date	Date	07/15-'19	Title	Power Connector-4P 90° (Copper Piece)	
.X ~ ±0.35				LDF	07/18-'19	Sheet	1 of 1			
.XX ~ ±0.25				Approval By	Date	Third Angle Projection				
.XXX ~ ±0.15				Nancy	07/19-'19					
Angle ~ ± 3°							Drawing No.	WPOD-04MS-AN-N084	REV	D