

REV.	ECN.NO.	DATE
A	RELEASED	07/02-'18
E	Add "No Mark" Specification	09/22-'21
F	1.Modify tolerance dimensions 2.Modify product structure 3.Modify Notes	08/01-'22

NOTES

***Material**

Housing: LCP, UL 94V-0.
 Contact: Brass.
 Plating: Au plating on contact area.
 Sn(100u" min.) plating on solder tail.
 Ni (50u" min.) underplating overall.
 Harpoon: Brass.
 Plating: Sn(100u" Min.) plating overall.
 Ni(50u" Min.) underplating overall.

***Mechanical**

Insertion Force: 59N max.
 Withdrawal Force: 6N min.
 Durability: 500 cycles.

***Electrical Specification**

Current Rating: 1.5 Ampere per power contact.
 Contact Resistance: 30 mΩ max.
 Insulation Resistance: 1000 MΩ min.
 Dielectric Withstanding Voltage: 500 VAC.

***Environmental**

Operating Temperature: 0°C to +55°C.

***How to order**

Series No. **WSFM-68F1L1BHW5**

Number of Contacts: 5: Reel
 W: Winning Mark
 H: Halogen Free+
 RoHS-Compliance
 B: Brass
 1: Black
 L: LCP

Au A: 1u" D: 15u"
 F: 30u"

1: SMT (Reverse Subside Type)
 (0.55)

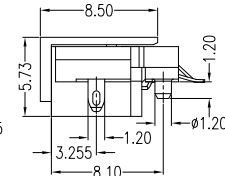
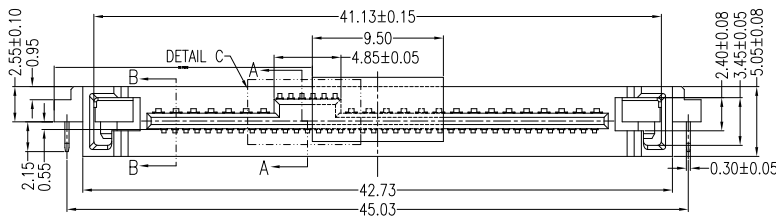
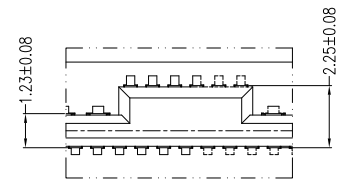
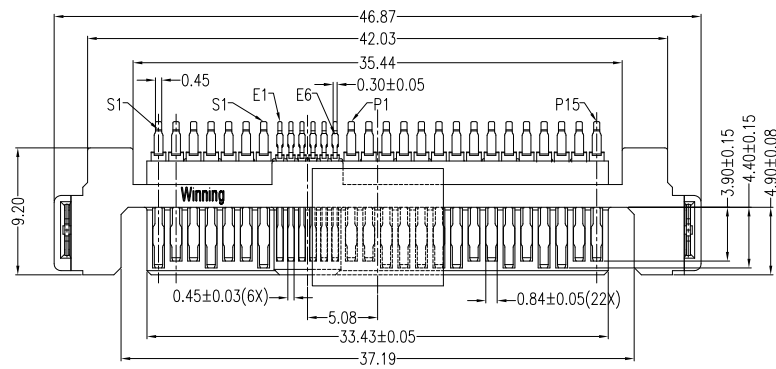

SECT A-A

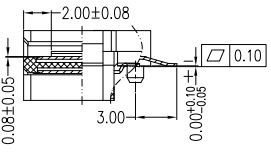

SECT B-B

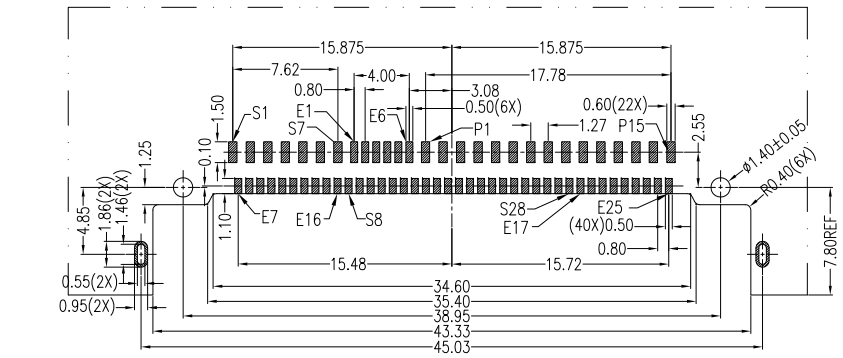
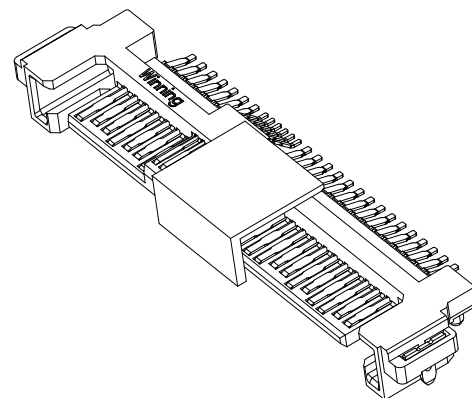
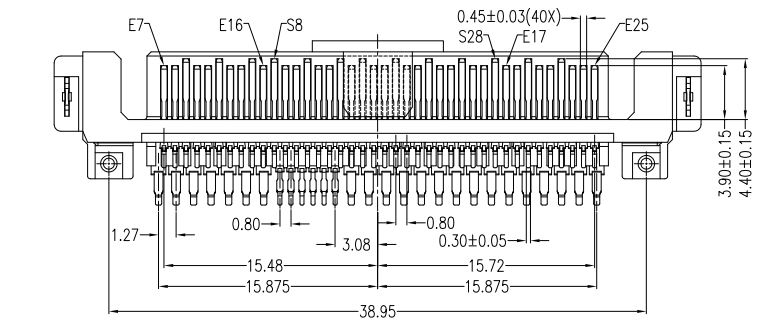

PCB LAYOUT(T=1.60mm)
 COMPONENT SIDE

REV	Units	mm	Scale	5:3	Drawing By	Date	WIN WIN PRECISION IND. CO., LTD.	
REV	Modify tolerance dimensions:0.30 → 0.30±0.05, 0.30 → 0.30±0.05, 0.30 → 0.30±0.05; 2.Modify product structure; 3.Modify Notes.						WINNING TEL: 886-2-22994155 FAX: 886-2-22994157	
Zym	Tolerance Unless Otherwise Specified		Date		08/01-'22	Date	08/01-'22	Title
Charles	.X ~ ±0.35		Reviewed By		08/01-'22	Sheet	1 of 1	
Nancy	.XX ~ ±0.25		Approval By		08/02-'22	Third Angle Projection	SAS/PCIe 68P SMT (Reverse Subside Type) (0.55) Male	
	.XXX ~ ±0.15		Date		08/02-'22	Drawing No.		WSPM-68PS-AN-W489
Angle	~ ± 3°		Date		08/02-'22	REV		F