

REV.	ECN.NO.	DATE
A	RELEASED	04/06-'23

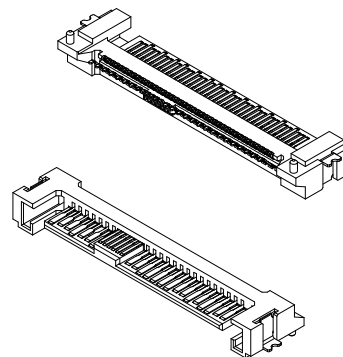

NOTE

Material:
Housing: UL 94V-0, LCP E130i, Black
Terminal: Copper Alloy, C2680, T=0.2±0.01mm
Forklock: Copper Alloy, C2680, T=0.3±0.01mm
Finished:
Contact: 15u" Au Plating On Contact Area,
Mattie Tin Plating On Solder Tail Area,
Nickel Under.

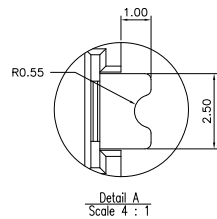
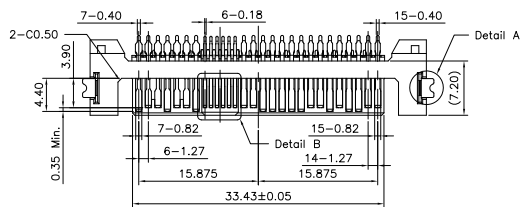
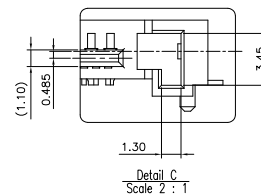
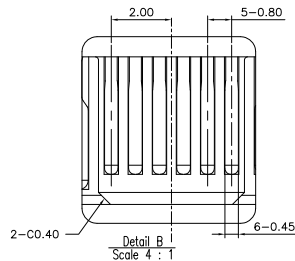
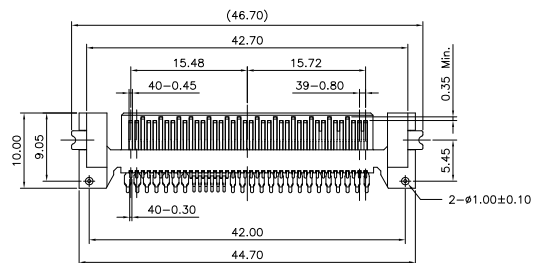
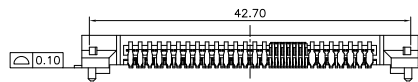
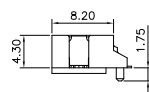
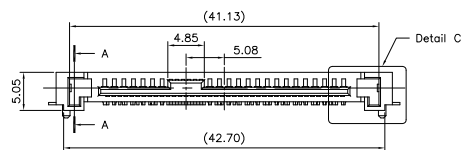

***How to order**

WSFM-68DAL1CU5T45

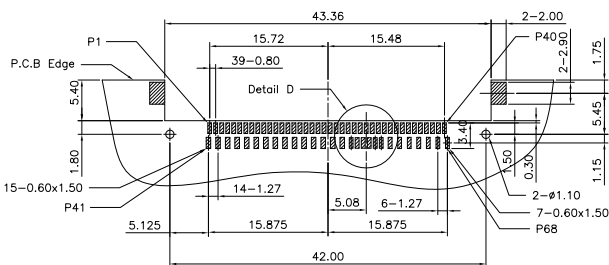
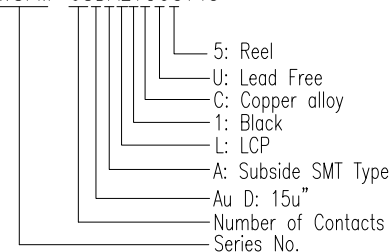

Recommended P.C.B. Layout
Layout Tolerance = ± 0.05mm

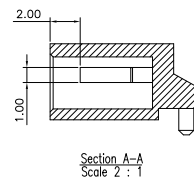
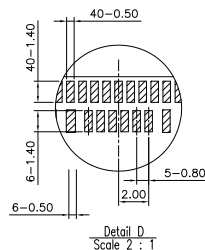

REV		Units	mm	Scale	1:1	Drawing By	Date	WIN WIN PRECISION IND. CO., LTD.	
		Tolerance Unless Otherwise Specified				Lily	04/06-'23	WINNING TEL: 886-2-22994155 FAX: 886-2-22994157	
X.X	=±0.20					Lulu	04/06-'23	Date	04/06-'23
X.XX	=±0.15					Robert	04/06-'23	Sheet	1 of 1
X.X°	=±3°							Title	SFF 8639 68PIN Male For PCI-E 4.0 Subside SMT Type
								Third Angle Projection	
								Drawing No.	WSFM-68DAL1CU5T45
								REV	A