

REV.	ECN.NO.	DATE
A	RELEASED	09/30/08
D	Modify Notes	10/16/13
E	Modify Size Tolerance	07/30-'14

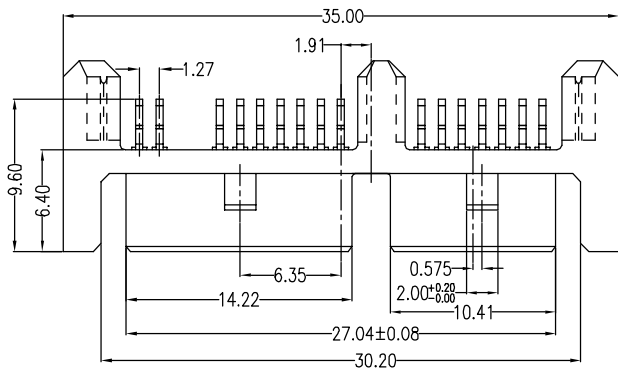

Pin Number	Signal Name	Description
S1	GND	
S2	A+	Differential Signal
S3	A-	
S4	GND	
S5	B-	Differential Signal
S6	B+	
S7	GND	

Pin Number	Power Designation
P1	+3.3V
P2	+3.3V
P3	GND
P4	GND
P5	+5V
P6	+5V
P7	Reserved
P8	Optional
P9	Optional

**NOTES:**

**\*Material**

Housing: LCP, UL 94V-0 rated, Color: Black;  
 Contact: Brass;  
 Plating: Au Plating On Contact Area;  
 Sn(100u" Min.) Plating On Solder Tail;  
 Ni(50u" Min.) Underplating Overall

**\*Mechanical**

Insertion Force: 45N max.  
 Withdrawal Force: 10N min.  
 Durability: 500 cycles

**\*Electrical Specification**

Current Rating: 1.5 Ampere per contact;  
 Contact Resistance: 30 Milliohms max.  
 Insulation Resistance: 1000 megohms min.  
 Dielectric Withstanding Voltage: 500 V AC.

**\*Environmental**

Operating Temperature: -55°C to +85°C

**\*How to Order:**

WATV-16D7L1BU4

- 4: Tube
- U: Lead Free
- B: Brass
- 1: Black
- L: LCP
- 7: Straddle(6.4)
- Au: A:>0.8u", D:15u", F:30u"
- NO. of Contacts
- Series No.

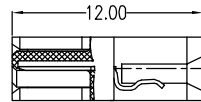
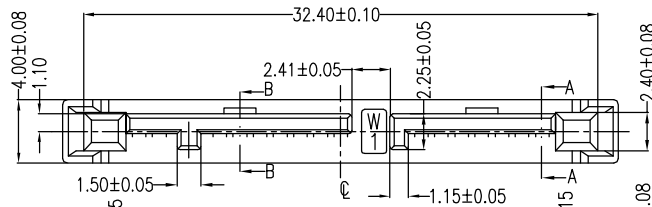

Section:A-A

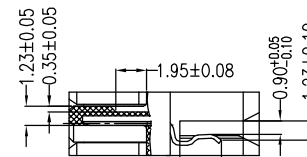

Section:B-B

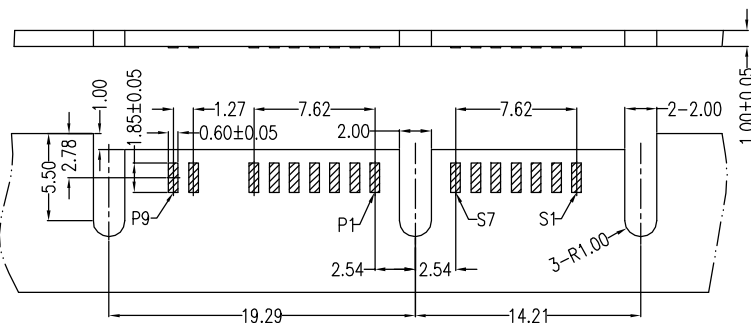
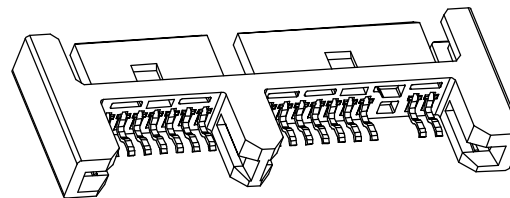
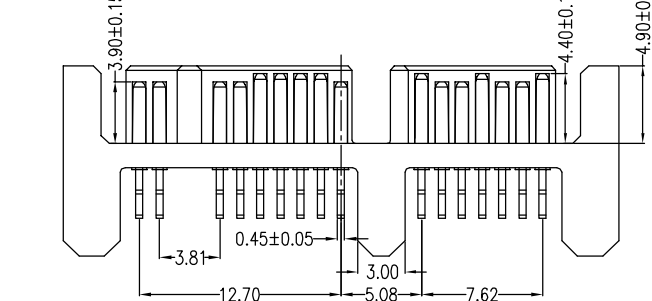

RECOMMENDED PCB LAYOUT

REV/Modify Size Tolerance		Drawing By		Date		WIN WIN PRECISION IND. CO., LTD.	
Units	mm	Scale	2:1	XHQ	07/30-'14	TEL: 886-2-22994155 FAX: 886-2-22994157	
Tolerance Unless Otherwise Specified				Reviewed By	Date	Date	06/01/09
.X ~ ±0.35				Blue	08/01-'14	Sheet	1 of 1
.XX ~ ±0.25				Approval By	Date	Title	
.XXX ~ ±0.15				Richard	08/07-'14	Micro SATA 7+7+2P Straddle Male(6.4)	
Angle ~ ± 3°				Third Angle Projection		Drawing No.	WATV-16PS-AN-N245
						REV	E