

REV.	ECN.NO.	DATE
A	RELEASED	06/17-'03
E	Update Drawings standard	06/08/11
F	Modify View and Add Notes	06/04-'20

Notes:

***Material**

Housing: LCP UL 94V-0 rated;
 Color: Black.
 Contact: Phosphor Bronze
 Plating: Au Plating On Contact Area;
 Sn(100u" Min.) Plating On Solder Tail;
 Ni(50u" Min.) Underplating Overall
 Harpoon: Brass
 Plating: Sn(100u"Min)Plating Over Ni(50u"Min)

***Mechanical**

Insertion Force: 45N Max;
 Withdrawal Force: 10N Min;
 Durability: 500 cycles.

***Electrical Specification**

Current Rating: 1.5 Ampere per contact
 Contact Resistance: 30mΩ max.
 Insulation Resistance: 1000MΩ min.
 Dielectric Withstanding Voltage: 500V AC

***Environmental**

Operating Temperature: -55°C to +125°C

***How To Order**

WATR-22DL1P7U

- Blank: No Mark
- U: Lead Free
- 7: DIP Type Double Row (Short Distance)(ø2.6)
- P: Phosphor Bronze
- 1: Black
- L: LCP
- Au: A:>0.8u"; B:5u"; D:15u"
- NO. of Contacts
- Riser Card

Signal Segment		Power Segment			
Name	Type	Name	Type	Name	Type
S1	GND	P1	V3.3	P9	V5
S2	A+	P2	V3.3	P10	GND
S3	A-	P3	V3.3	P11	DAS/DSS
S4	GND	P4	GND	P12	GND
S5	B-	P5	GND	P13	V12
S6	B+	P6	GND	P14	V12
S7	GND	P7	V5	P15	V12
		P8	V5		

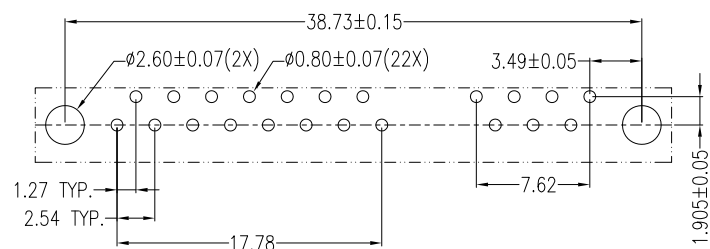
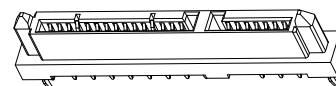
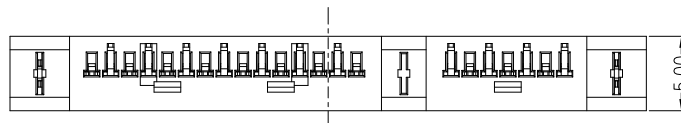
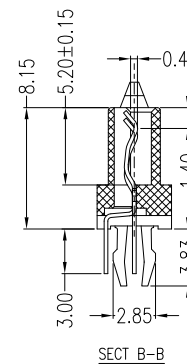
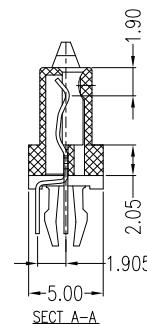
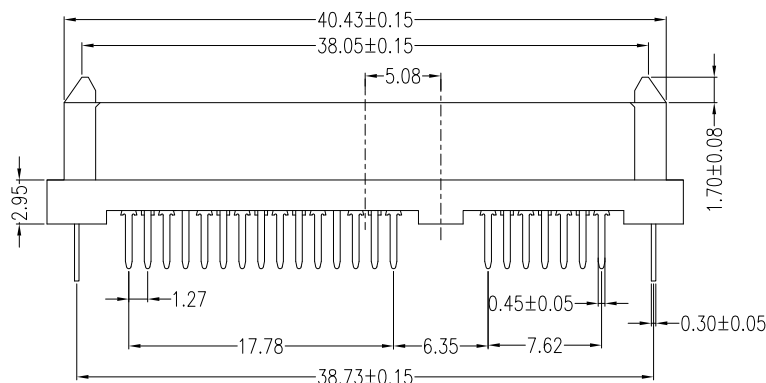
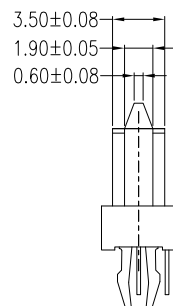
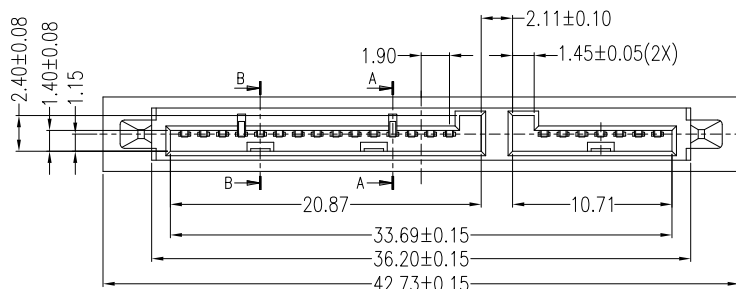

REV	Modify View and Add Notes: 1.Modify 3D View 2.Contact Plating Ni(40u"Min) → Ni(50u") 3.Add Harpoon and Plating			Units	mm	Scale	4:1	Drawing By	Date	
								WWY	06/04-'20	
								Reviewed By	Date	
								LDF	06/04-'20	
								Approval By	Date	
								Nancy	06/09-'20	
Tolerance Unless Otherwise Specified								WIN WIN PRECISION IND. CO., LTD. TEL: 886-2-22994155 FAX: 886-2-22994157		
.X	±0.35			Date	06/04-'20		Date		06/04-'20	
.XX	±0.25			Sheet	1 of 1		Title		Serial ATA 7+15P DIP Type Double Row Female	
.XXX	±0.15			Third Angle Projection				Drawing No.		WATR-22PS-AN-N044
Angle	± 3°							REV		F