

REV.	ECN.NO.	DATE
A	RELEASED	04/07/10
B	Change Notes	07/23-'11
C	Modify View of housing	03/16-'16

Pin Number	Signal Name	Pin Number	Power Line Designation
S1	GND	P1	DP
S2	A+	P2	+5V
S3	A-	P3	+5V
S4	GND	P4	MD
S5	B-	P5	GND
S6	B+	P6	GND
S7	GND		

Notes:

***Material**

Housing: LCP, UL 94V-0 rated;
 Color: Black.
 Contact: Phosphor Bronze
 Plating: Au Plating on contact area
 Sn(100u"Min) plating on solder Tail.
 Ni(40u"Min) contact underplating overall.
 Harpoon: Brass
 Plating: Sn(100u"Min) plating on solder Tail.
 Ni(40u"Min) contact underplating overall.

***Mechanical**

Insertion Force: 45N max.
 Withdrawal Force: 10N min.
 Durability: 500cycles

***Electrical Specification**

Current Rating: 1.5 Ampere per contact
 Contact Resistance: 30mΩ max.
 Insulation Resistance: 1000MΩmin.
 Dielectric Withstanding Voltage: 500 VAC

***Environmental**

Operating Temperature: -55°C to +85°C

***How to Order:**

WATN-13D1L1PU3

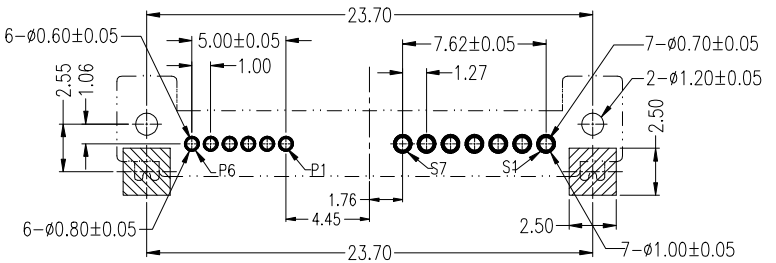
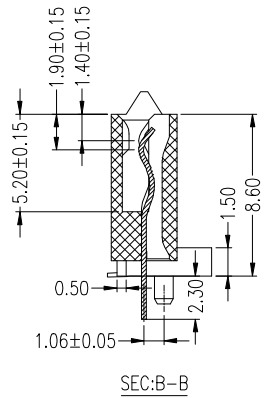
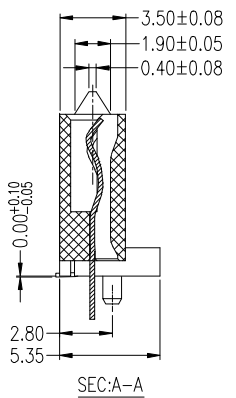
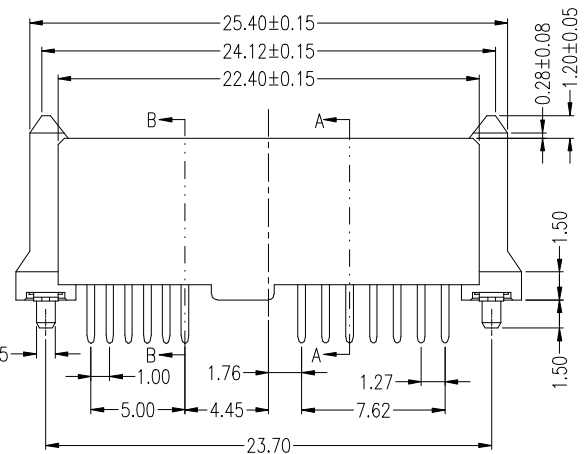
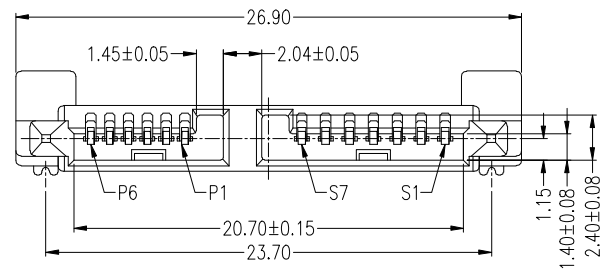
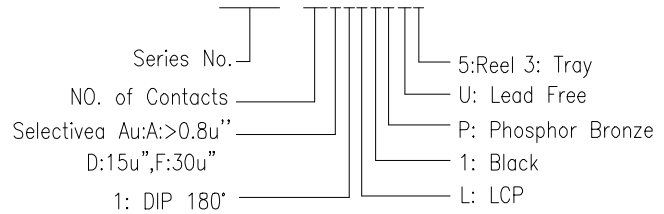

RECOMMENDED PCB LAYOUT T=1.60mm
 (Tol±0.05)

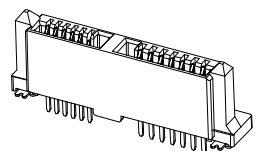

REV	Modify View of housing		Drawing By	Date	WIN WIN PRECISION IND. CO., LTD. TEL: 886-2-22994155 FAX: 886-2-22994157
Units	mm	Scale	Hxy	03/16-'16	
Tolerance Unless Otherwise Specified			Reviewed By	Date	Date
.X ~ ±0.35			kiven	03/17-'16	03/16-'16
.XX ~ ±0.25			Approval By	Date	Sheet
.XXX ~ ±0.15			Roger	03/22-'16	1 of 1
Angle ~ ± 3°			Third Angle Projection		Title
					S ATA 7+6P Vertical DIP Female (With Post)
					Drawing No. WATN-13PS-AN-N336
					REV
					C