

REV.	ECN.NO.	DATE
A	RELEASED	05/03-'11
I	Modify View	09/22-'21
J	Add electroplating specification Au 30u"	10/22-'22

Power Segment	
Name	Type
P1	V3.3
P2	V3.3
P3	V3.3
P4	GND
P5	GND
P6	GND
P7	V5
P8	V5
P9	V5
P10	GND
P11	DAS/DSS
P12	GND
P13	V12
P14	V12
P15	V12

Signal Segment	
Name	Type
S1	GND
S2	A+
S3	A-
S4	GND
S5	B-
S6	B+
S7	GND

NOTES:

***Material**

Housing: LCP UL 94V-0.
 Contact: Brass.
 Plating: Au Plating on contact area.
 Sn(100u"Min) plating on solder Tail.
 Ni(40u"Min) contact underplating overall.
 Harpoon: Brass.
 Plating: Sn (100u" Min.) plating overall.
 Ni (50u" Min.) underplating overall.

***Mechanical**

Insertion Force: 45N max.
 Withdrawal Force: 10N min.
 Durability: 500 cycles.

***Electrical Specification**

Current Rating: 1.5 Ampere per contact.
 Contact Resistance: 30mΩ max.
 Insulation Resistance: 1000MΩ min.
 Dielectric Withstanding Voltage: 500 V AC.

***Environmental**

Operating Temperature: -55°C to +85°C.

***How to order**

WATHC-22D9L1BH 5
 5: Reel
 Blank: No Mark
 W: Winning Mark
 H: Halogen Free+RoHs Compliance
 B: Brass
 1: Black
 L: LCP
 9: SMT(Reverse Subside Type)(4.0)
 Au A: >0.8u" D: 15u" F: 30u"
 Number of Contacts
 Series No.

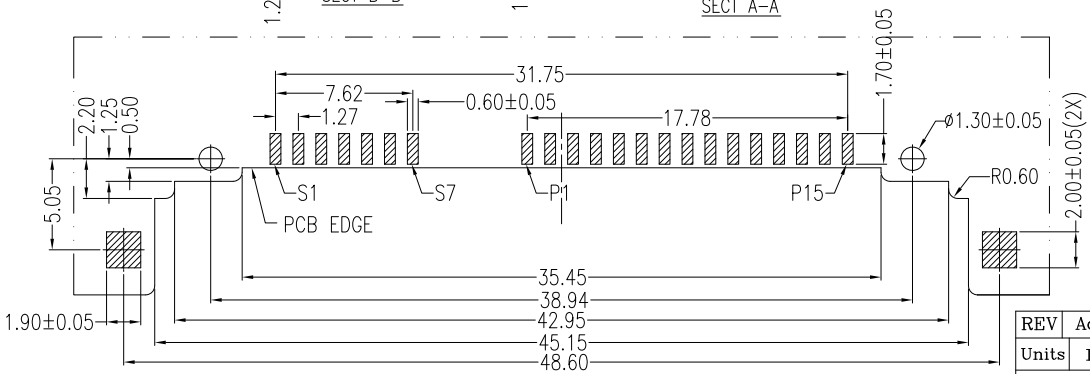
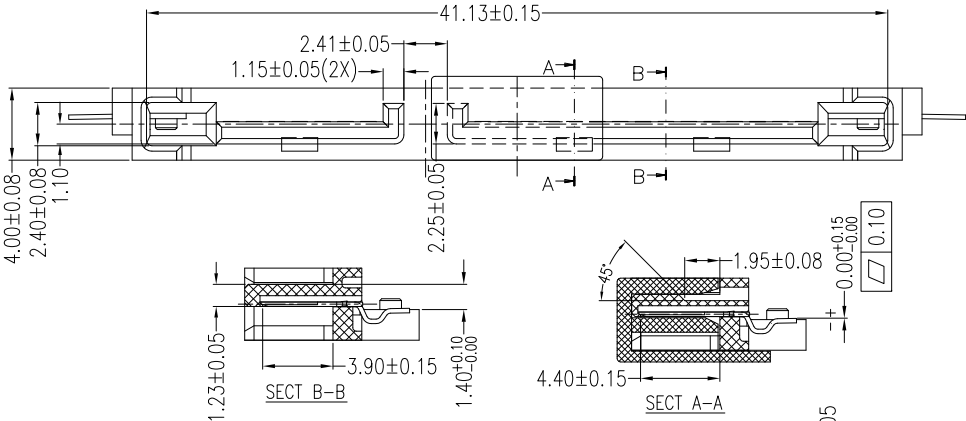
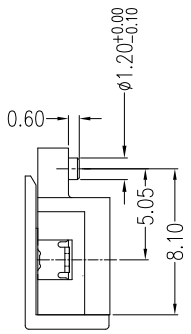
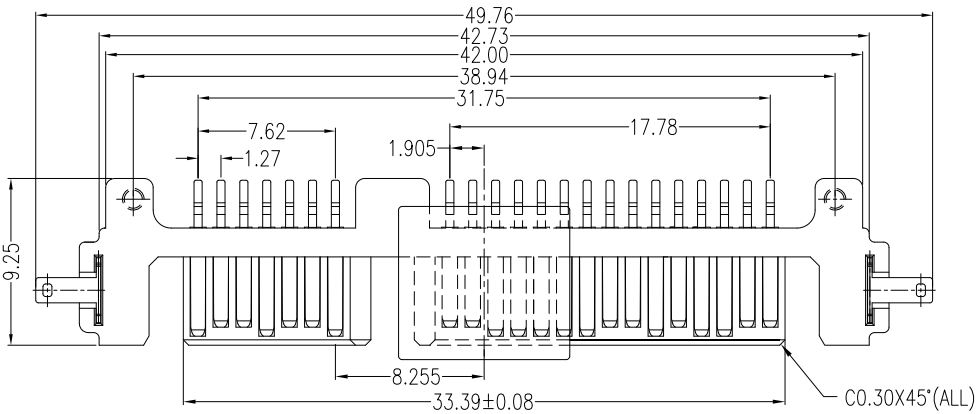
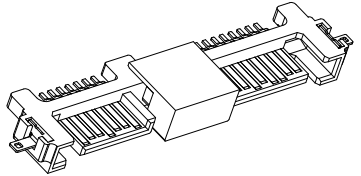

PCB LAYOUT(T=1.60)
 COMPONENT SIDE

REV	Add electroplating specification Au 30u"		
Units	mm	Scale	2:1
Tolerance Unless Otherwise Specified		Drawing By	Date
.X	~ ±0.35	GZ	10/22-'22
.XX	~ ±0.25	Reviewed By	Date
.XXX	~ ±0.15	Charles	10/24-'22
Angle	~ ± 3°	Approval By	Date
		Nancy	10/26-'22

WIN WIN PRECISION IND. CO., LTD.
 TEL: 886-2-22994155 FAX: 886-2-22994157

Date	10/22-'22	Title	Serial ATA 7+15P SMT (Reverse Subside Type) Male(4.0)
Sheet	1 of 1		
Third Angle Projection			
Drawing No.	WATHC-22PS-AN-N388	REV	J