

REV.	ECN.NO.	DATE
A	RELEASED	05/25/12
D	Modify View	06/15-'21
E	Add U: DIP Type(2.90)	10/28-'24

Power Segment			
PIN NO.	Type	PIN NO.	Type
P1	V3.3	P9	V5
P2	V3.3	P10	GND
P3	V3.3	P11	DAS/DSS
P4	GND	P12	GND
P5	GND	P13	V12
P6	GND	P14	V12
P7	V5	P15	V12
P8	V5		

NOTES:

- *Material**
Housing: LCP, UL 94V-0.
Contact: Brass.
Plating: Au plating on contact area.
Sn(100u" Min.) plating on solder tail.
Ni(50u" Min.) underplating overall.

***Mechanical**

- Insertion Force: 45N max.
- Withdrawal Force: 10N min.
- Durability: 500 cycles.

***Electrical Specification**

- Current Rating: 1.5 Ampere per contact.
- Contact Resistance: 30 mΩ max.
- Insulation Resistance: 1000 MΩ min.
- Dielectric Withstanding Voltage: 500V AC.

***Environmental**

- Operating Temperature: -55°C to +85°C

***How to order:**

- WATH-15DLBEU 3
- Blank: With-Post
 - 3: Tray
 - Blank: No Mark
 - U: Lead Free
 - E: DIP Type(2.10)
 - U: DIP Type(2.90)
 - B: Brass
 - L: LCP
 - Au: A: G/F D: 15u" F: 30u"
 - Number Of Contacts
 - Series NO.:SATA For H.D

A

B

C

D

A

B

C

D

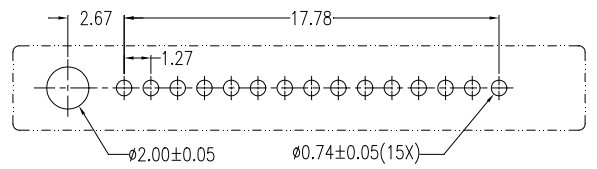
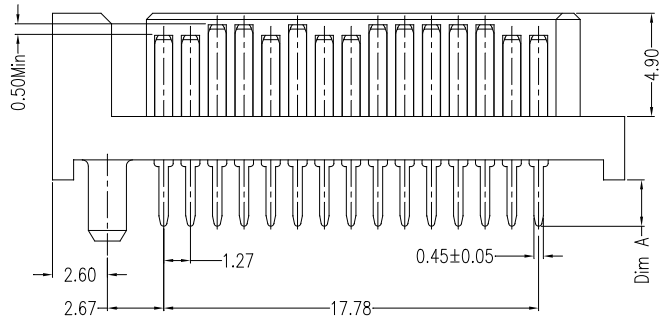
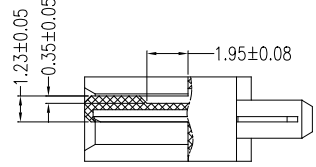
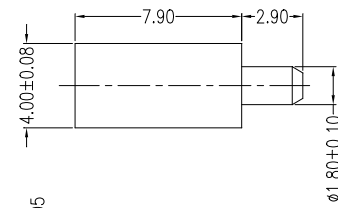
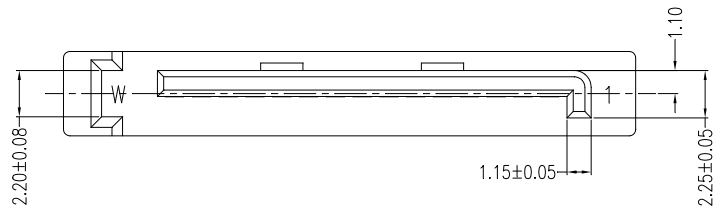
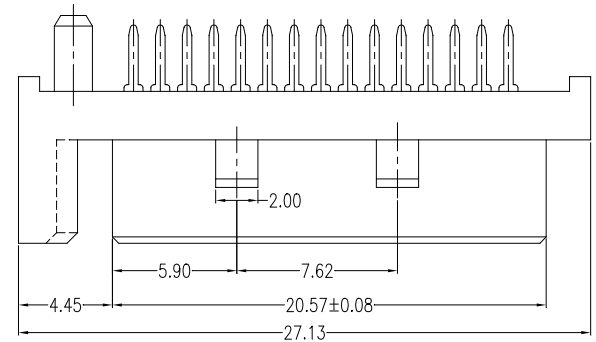

P.C.B LAYOUT(T=1.60mm)
COMPONENT SIDE

Unit:mm

Part NO.	Dim A
WATH-15*E***	2.10
WATH-15*U***	2.90

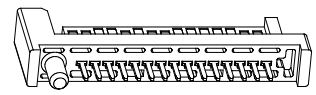

REV Add U: DIP Type(2.90)			Drawing By		Date	WIN WIN PRECISION IND. CO., LTD.		
Units	mm	Scale	ZXC		10/28-'24	TEL: 886-2-22994155 FAX: 886-2-22994157		
Tolerance Unless Otherwise Specified			Reviewed By	Date	Date	10/28-'24	Title SATA 15P DIP Male (Vertical Type)	
.X ~ ±0.35			LZX	10/28-'24	Sheet	1 of 1		
.XX ~ ±0.25			Approval By	Date	Third Angle Projection			
.XXX ~ ±0.15			Nancy	11/01-'24	Drawing No.			
Angle ~ ± 3°							WATH-15PS-AN-418	
							REV	E