

REV.	ECN.NO.	DATE
A	RELEASED	12/19-'06
G	Modify Material and How to order	07/21-'20
H	1.Modify View 2.Modify Specification	11/26-'20

NOTES:

***Material**

Housing: LCP, UL 94V-0 rated, Color: Black;
 Contact: Phosphor Bronze.
 Plating: Au Plating On Contact Area;
 Sn(100u* Min.) Plating On Solder Tail;
 Ni(50u* Min.) Underplating Overall
 Harpoon: Brass;
 Plating: Sn(100u* Min.) Plating On Solder Tail;
 Ni(50u* Min.) Underplating Overall

***Mechanical**

Insertion Force: 45N Max.
 Withdrawal Force: 10N Min.
 Durability: 500 Cycles.

***Electrical Specification**

Current Rating: 1.5 Ampere Per Contact;
 Contact Resistance: 30mΩ Max.
 Insulation Resistance: 1000MΩ Min.
 Dielectric Withstanding Voltage: 500V AC.

***Environmental**

Operating Temperature: -55°C to +85°C.

***How to order:**

- WATA-07 D P LHD 4 U
- Blank:Black
 - U:Lead Free
 - Blank:With-Post
 - 4:Tube Parking
 - Blank:No Mark
 - HD:Lie Semi Box Two Hole DIP Type(2.60)
 - HE:Lie Semi Box Two Hole DIP Type(2.15)
 - L:LCP
 - P:Phosphor Bronze
 - Gold A:>0.8u" D:15u" F:30u"
 - NO. of Contacts
 - Serial ATA for Card

Pin	SIGNAL NAME
S1	GND
S2	A+
S3	A-
S4	GND
S5	B-
S6	B+
S7	GND

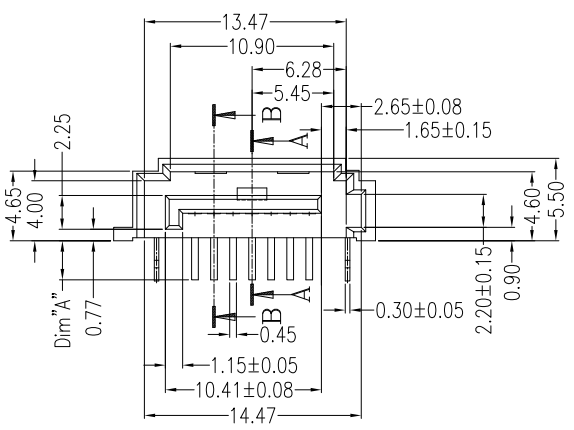
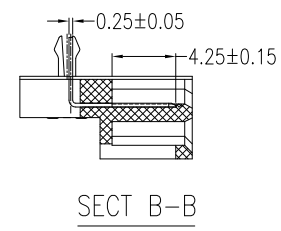
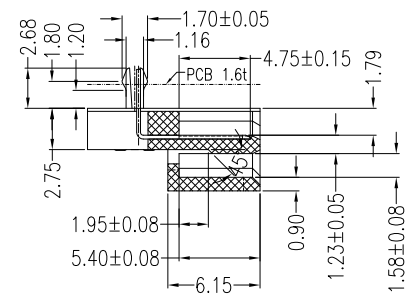
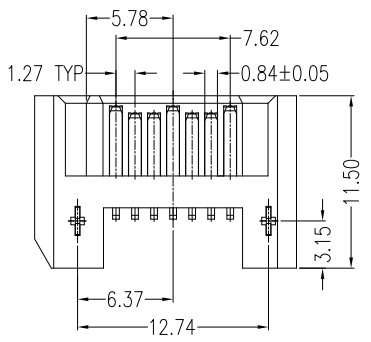
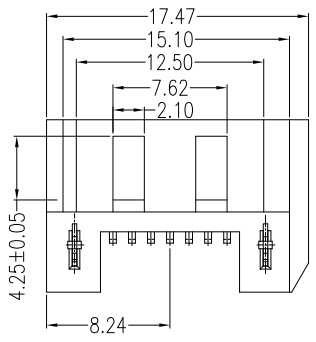

SECT A-A

SECT B-B

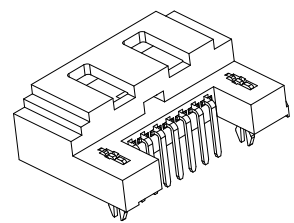

Unit:mm

Part Number	Dim "A"
WATA-07XPLHE_ 4_	2.15
WATA-07XPLHD_ 4_	2.60

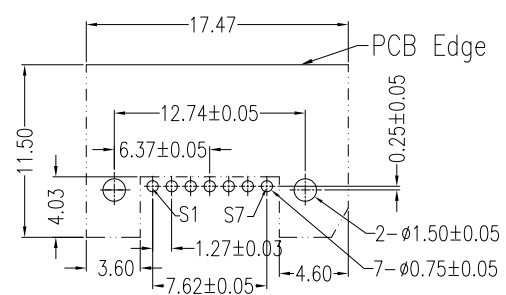

P.C.B. Layout
TOP VIEW(T=1.60)

REV	1.Modify View	2.Modify Specification		
Units	mm	Scale	2:1	
Tolerance Unless Otherwise Specified		Drawing By	Date	
.X	~ ±0.35	ZK	11/26-'20	
.XX	~ ±0.25	Reviewed By	Date	
.XXX	~ ±0.15	LZX	11/26-'20	
Angle	~ ± 3°	Approval By	Date	
		Nancy	12/01-'20	

WIN WIN PRECISION IND. CO., LTD.

TEL: 886-2-22994155 FAX: 886-2-22994157

Date: 11/26-'20

Sheet: 1 of 1

Title: Serial ATA 7P Semi Box Two Hole DIP Type Male Drawing

Third Angle Projection

Drawing No.	WATA-007MN-AN-N084	REV	H
-------------	--------------------	-----	---