

| REV. | ECN.NO. | DATE |
|------|------------------------------------|-----------|
| A | RELEASED | 10/27-'10 |
| F | Change of Color | 04/17-'19 |
| G | Corrected durability test criteria | 12/16-'19 |

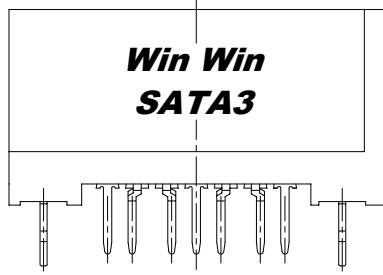

LOGO VIEW
SCALE 1:1

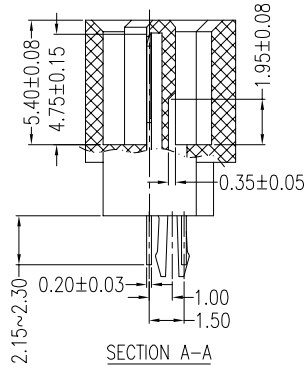

SECTION A-A

| PIN | SIGNAL NAME |
|-----|-------------|
| S1 | GND |
| S2 | A+ |
| S3 | A- |
| S4 | GND |
| S5 | B- |
| S6 | B+ |
| S7 | GND |

NOTES:

***Material**

Housing: Nylon46, UL94 V-0 Rated;
 Contact: Brass
 Plating: Au plating on contact area;
 Sn(100u" Min.) plating on solder tail;
 Ni(50u" Min.) underplating overall.
 Harpoon: Brass
 Plating: Sn(100u" Min.) plating over Ni(50u" Min.)

***Mechanical**

Insertion Force: 45N Max.
 Withdrawal Force: 10N Min.
 Durability: 500 cycles

***Electrical Specification**

Current Rating: 1.5 Ampere per contact
 Contact Resistance: 30mΩ Max.
 Insulation Resistance: 1000MΩ Min.
 Dielectric Withstanding Voltage: 500V AC

***Environmental**

Operating Temperature: -55°C to +85°C

***How to Order**

WAT3M-07A1G3BU4W

- W: Winning Mark
- 4: Tube
- U: Lead Free
- B: Brass
- 1: Black; 3: White; 4: Blue(286U); K: Red(185C)
- G: Nylon46
- 1: Straight 7P Shield(Two Hold)Dip Type
- Au: A:>0.8u"; D:15u"; F:30u"
- Number Of Contact
- Serial ATA 3.0

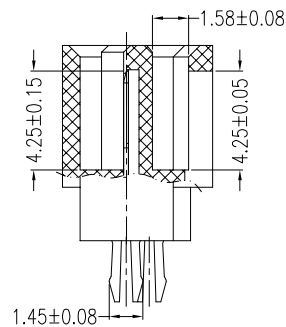
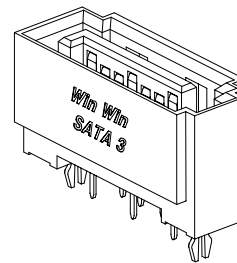
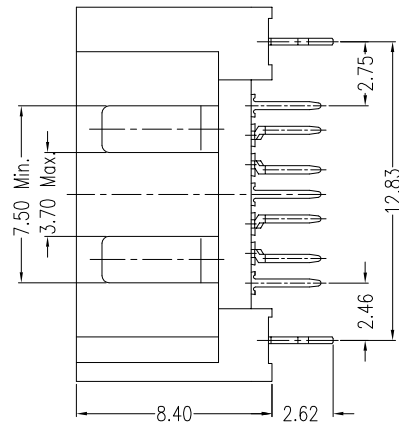
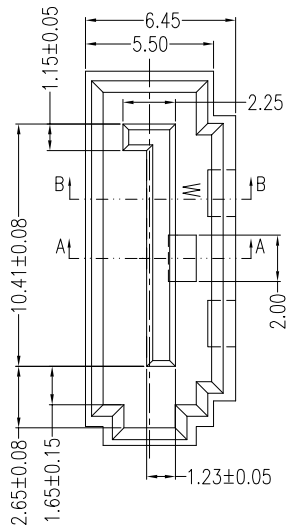
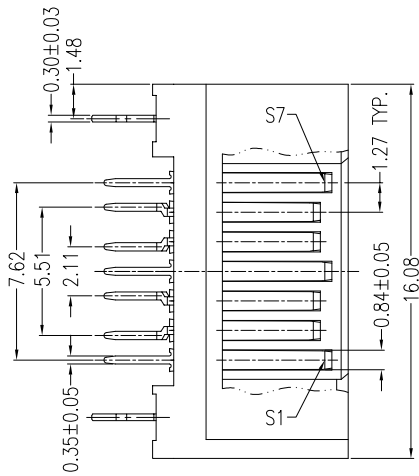

SECTION B-B

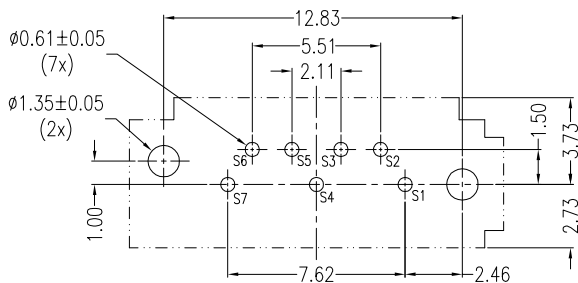

PCB LAYOUT(T=1.60mm)
COMPONENT SIDE

| REV | Corrected durability test criteria | | Drawing By | | Data | | WIN WIN PRECISION IND., CO., LTD. | |
|--------------------------------------|------------------------------------|-------|------------|-------------|-----------|---|-----------------------------------|---|
| Units | mm | Scale | 3:1 | CXS | 12/16-'19 | TEL: 886-2-22994155 FAX: 886-2-22994157 | | |
| Tolerance Unless Otherwise Specified | | | | Reviewed By | Data | | Date | Title |
| .X ~ ±0.35 | | | | LDF | 12/16-'19 | | 12/16-'19 | |
| .XX ~ ±0.25 | | | | Approval By | Data | | 1 of 1 | |
| .XXX ~ ±0.15 | | | | Nancy | 12/17-'19 | | Third Angle Projection | S ATA 3.0 7P Straight DIP Type Shield (Two Hold) Male |
| Angle ~ ± 3° | | | | | | | | Sheet |
| | | | | | | | | Drawing No. |
| | | | | | | | | WAT3M-07PS-AN-W358 |
| | | | | | | | | REV |
| | | | | | | | | G |