

REV.	ECN.NO.	DATE
A	RELEASED	09/30-'10
G	ADD STAND OFF	11/22-'16
H	Modify Notes	04/10-'17

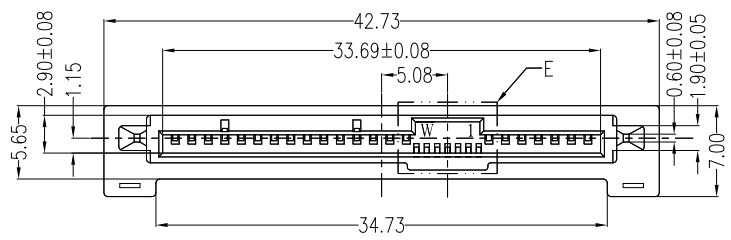

Signal Segment			
Pin NO.	Type	Name	Type
S1	Signal Ground	S8	Signal Ground
S2	TP+	S9	TS+
S3	TP-	S10	TS-
S4	Signal Ground	S11	Signal Ground
S5	RP-	S12	RS-
S6	RP+	S13	RS+
S7	Signal Ground	S14	Signal Ground

Power Segment			
Pin NO.	Type	Name	Type
P1	V3.3	P9	V5
P2	V3.3	P10	Ground
P3	V3.3	P11	Ready Led
P4	Ground	P12	Ground
P5	Ground	P13	V12
P6	Ground	P14	V12
P7	V5	P15	V12
P8	V5		

NOTES:

***Material**

Housing: Nylon9T, UL 94V-0 rated, Color: Black
 Contact: Phosphor Bronze;
 Plating: Au Plating on contact area
 Sn(100u"Min) plating on solder Tail.
 Ni(50u"Min) contact underplating overall.

***Mechanical**

Insertion Force: 25N max.
 Withdrawal Force: 5N min.
 Durability: 50 cycles

***Electrical Specification**

Current Rating: 1.5 Ampere per contact;
 Contact Resistance: 30 mΩ max.
 Insulation Resistance: 1000 MΩ min.
 Dielectric Withstanding Voltage: 500 VAC.

***Environmental**

Operating Temperature: 0°C to +55°C

***How to order**

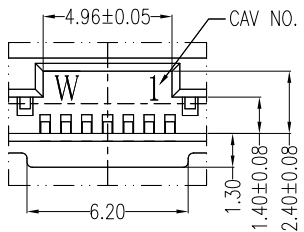
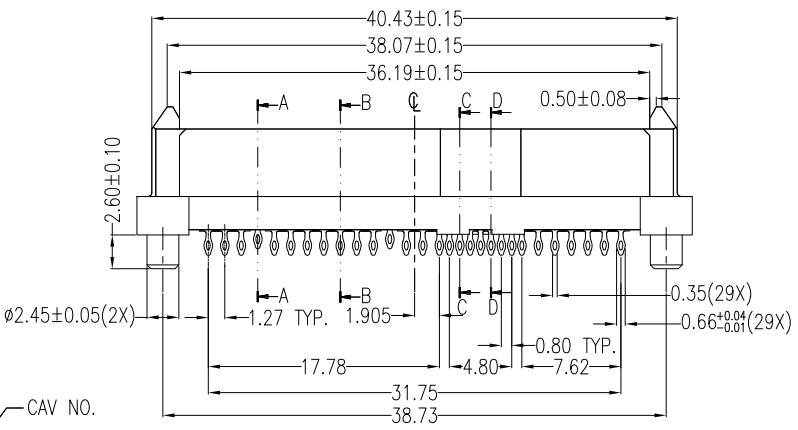
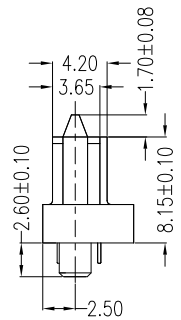
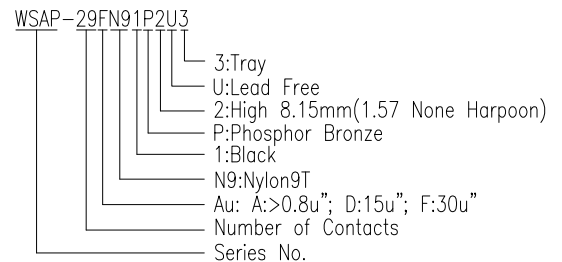

VIEW E
SCALE 2:1

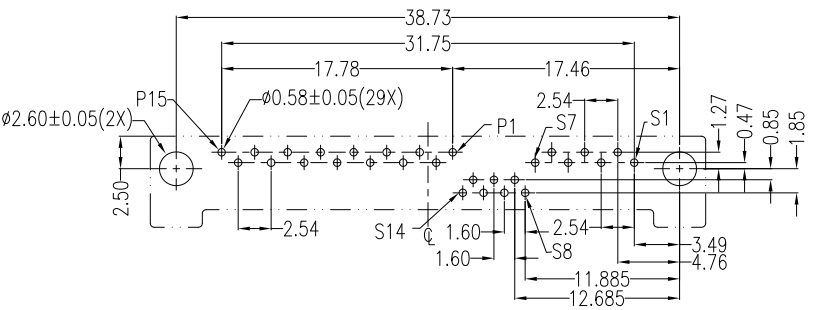
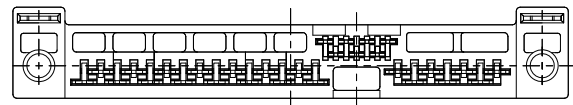

PCB LAYOUT(T=1.60mm)
COMPONENT SIDE

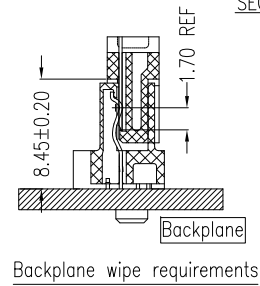

Backplane wipe requirements

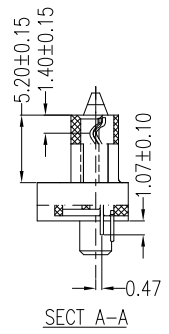

SECT A-A

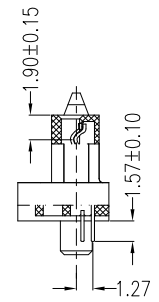

SECT B-B

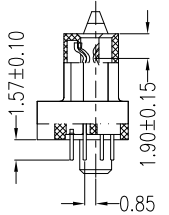

SECT C-C

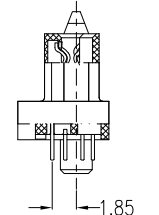

SECT D-D

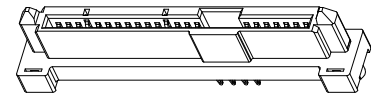

REV	Modify Notes	Drawing By	Date	WIN WIN PRECISION IND. CO., LTD. TEL: 886-2-22994155 FAX: 886-2-22994157	
Units	mm Scale 5:3	Lulu	04/18-'17	Date	04/10-'17
Tolerance Unless Otherwise Specified		Reviewed By	Rosh	Sheet	1 of 1
.X	~ ±0.35	Approval By	Roger	Third Angle Projection	Title
.XX	~ ±0.25				SAS 29P Vertical Double Row Female (Press Fit 1.57)
.XXX	~ ±0.15				
Angle	~ ± 3°				
		Drawing No	WSAP-22PS-AN-N356	REV	H