

REV.	ECN.NO.	DATE
A	RELEASED	10/19-'05
E	Modify Layout Dimension	11/08-'10
F	Modify Durability	09/26-'18

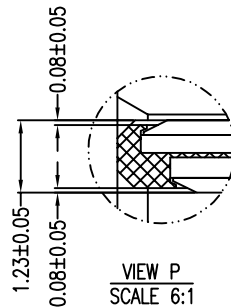
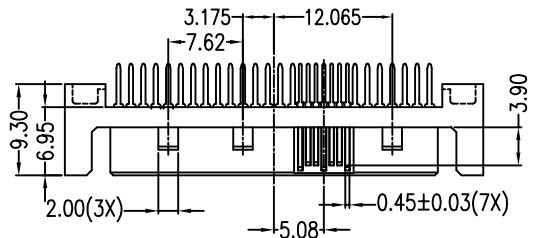

Signal Segment		Power Segment	
Pin NO.	Type	Pin NO.	Type
S1	GND	P1	V3.3
S2	A+	P2	V3.3
S3	A-	P3	V3.3
S4	GND	P4	GND
S5	B+	P5	GND
S6	B-	P6	GND
S7	GND	P7	V5
S8	GND	P8	V5
S9	A+	P9	V5
S10	A-	P10	GND
S11	GND	P11	DAS/DSS
S12	B-	P12	GND
S13	B+	P13	V12
S14	GND	P14	V12
		P15	V12

NOTES:

***Material**

Housing: LCP, UL 94V-0 rated, Color: Black;
 Contact: Brass;
 Plating: Au plating on contact area;
 Sn(100u" min.) plating on solder tail;
 Ni(50u" min.) underplating overall.

***Mechanical**

Insertion Force: 25N max.
 Withdrawal Force: 5N min.
 Durability: 500 cycles

***Electrical Specification**

Current Rating: 1.5 Ampere per contact;
 Contact Resistance: 30 mΩ max.
 Insulation Resistance: 1000 MΩ min.
 Dielectric Withstanding Voltage: 500 VAC.

***Environmental**

Operating Temperature: 0°C to +55°C

***How to order**

WSAM-29F1L1BU 4

- 4:Tube
- W:Winning Mark Blank:No Mark
- U:Lead Free
- B:Brass
- 1:Black
- L:LCP
- 1:Standard Type(180°)
- Au A:>0.8u" D:15u" F:30u"
- Number of Contacts
- Series No.

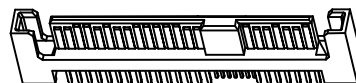
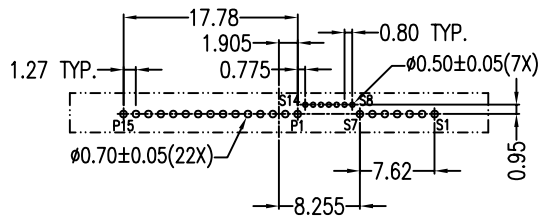
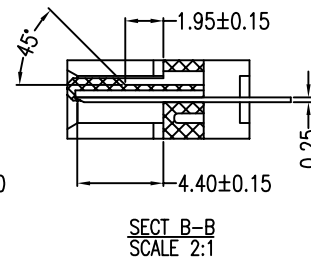
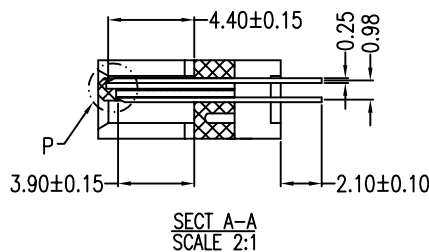
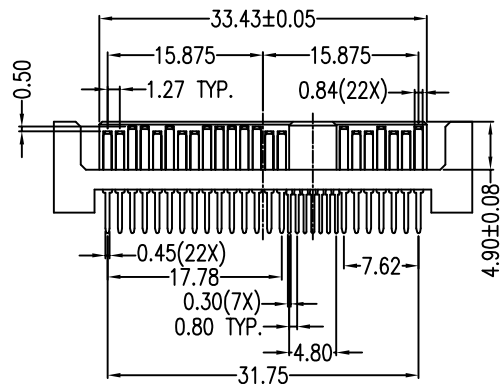
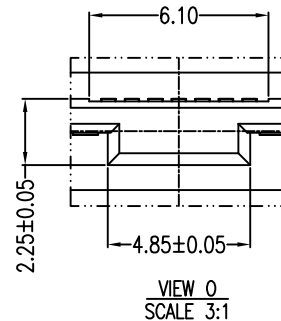
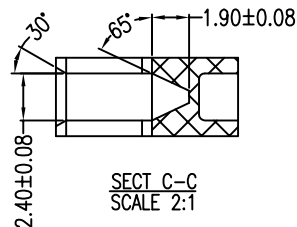
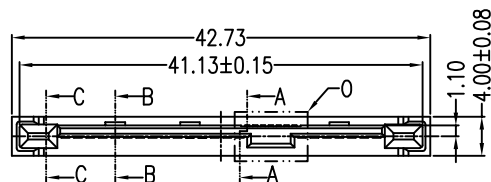

REV		According specification		Modify Durability	
Units	MM	Scale	5:4	Drawing By	Date
Tolerance Unless Otherwise Specified				LZX	09/26-'18
.X	~ ±0.35		Reviewed By	Date	
.XX	~ ±0.25		LDF	09/27-'18	
.XXX	~ ±0.15		Approval By	Date	
Angle	~ ± 3°		Nacey	10/08-'18	

WIN WIN PRECISION IND. CO., LTD			
TEL: 886-2-2299455 FAX: 886-2-22994157			
Date	09/26-'18	Title	SAS 29P Standard Type(180°) Male
Sheet	1 of 1		
Drawing No.		WSAM-29PS-AN-N133	REV
			F