

Power Segment			
Pin NO.	Type	Name	Type
P1	V3.3	Pg	V5
P2	V3.3	P10	Ground
P3	V3.3	P11	Ready Led
P4	Ground	P12	Ground
P5	Ground	P13	V12
P6	Ground	P14	V12
P7	V5	P15	V12
P8	V5		

Signal Segment			
Pin NO.	Type	Name	Type
S1	Signal Ground	S8	Signal Ground
S2	TP+	S9	TS+
S3	TP-	S10	TS-
S4	Signal Ground	S11	Signal Ground
S5	RP-	S12	RS-
S6	RP+	S13	RS+
S7	Signal Ground	S14	Signal Ground

REV.	ECN.NO.	DATE
A	RELEASED	03/18/05
D	Add Tolerance Modify Notes Add Pin Definition	08/27/10
E	Add Dimension	01/14-'16
F	Modify tolerance	02/18-'16

NOTES:

***Material**

Housing: LCP, UL 94V-0 rated, Color: Black;
 Contact: Phosphor Bronze;
 Plating: Au plating on contact area, Sn(100u" min.) plating on solder tail, Ni (40u" min.) underplating overall
 Harpoon: Phosphor Bronze;
 Plating: Sn plating(100u" min.) over Ni(40u" min.).

***Mechanical**

Insertion Force: 25N max.
 Withdrawal Force: 5N min.
 Durability: 500 cycles

***Electrical Specification**

Current Rating: 1.5 Ampere per contact;
 Contact Resistance: 30 mΩ max.
 Insulation Resistance: 1000 MΩ min.
 Dielectric Withstanding Voltage: 500 VAC.

***Environmental**

Operating Temperature: 0°C to +55°C

***How to order**

WATD-29F1L1PU 4

- 4:Tube
- W:Winning Mark Blank:No Mark
- U:Lead Free
- P:Phosphor Bronze
- 1:Black
- L:LCP
- 1:Standard Type(180°)
- Au A:>0.8u" D:15u" F:30u"
- Number of Contacts
- Series No.

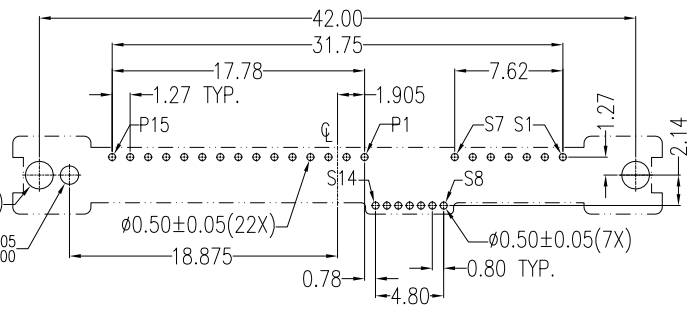
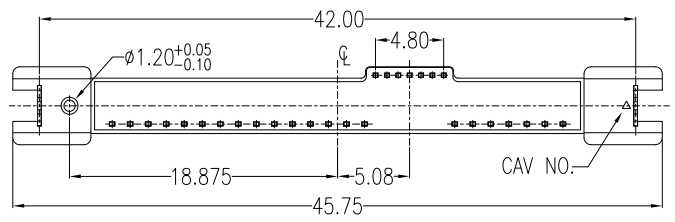
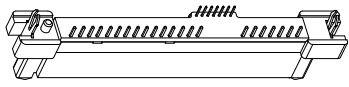
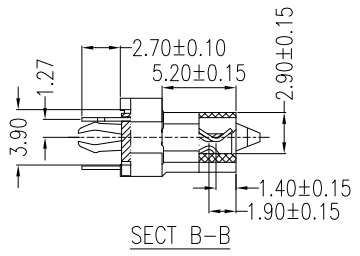
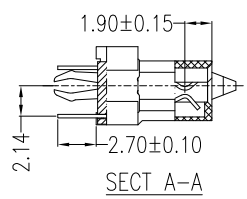
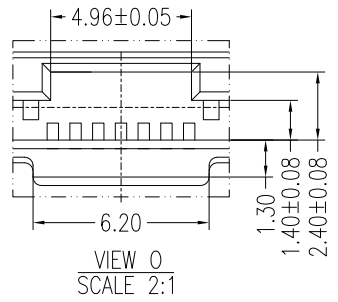
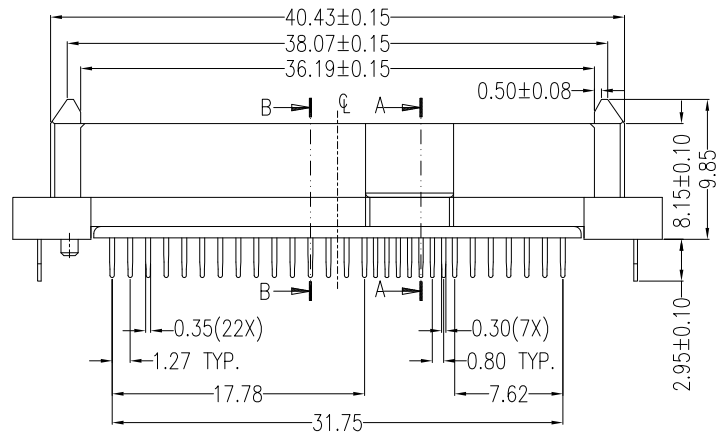
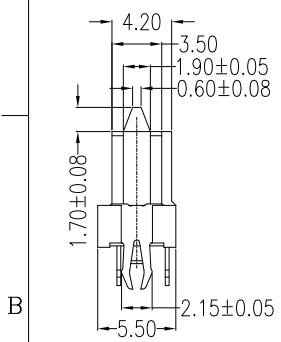

PCB LAYOUT(T=1.60mm)
COMPONENT SIDE

REV	Modify tolerance: 1.20±0.05 → 1.20±0.05/0.10	
Units	mm	Scale 5:3
Drawing By		Date
lhp.liu		02/24-'16
Reviewed By		Date
Kiven		02/24-'16
Approval By		Date
Roger		02/24-'16

WIN WIN PRECISION IND. CO., LTD.
 TEL: 886-2-22994155 FAX: 886-2-22994157

Date: 02/18-'16
 Sheet: 1 of 1
 Title: SAS 7+15+7P Straight DIP Female
 Third Angle Projection

Drawing No: WATD-29PS-AN-N111 REV F