

REV.	ECN.NO.	DATE
A	RELEASED	03/13-'23
B	Modify View	07/25-'23
C	Modify Harpoon	04/07-'24

**NOTES:**

**\*Material**

Housing: High temp thermoplastic, UL94V-0.  
 Insert Molding: High temp thermoplastic, UL94V-0.  
 Cap: High temp thermoplastic, UL94V-0.  
 Contacts: Copper Alloy.  
 Plating: Au Plating on Contact Area.  
           Sn (100u" Min.) plating on solder tail.  
           Ni (50u" Min.) underplating overall.  
 EMI: Stainless steel.  
 Harpoon: Copper Alloy.  
 Plating: Sn(100u" Min.) Plating Overall.  
           Ni(50u" Min.) Underplating Overall.

**\*Mechanical:**

Insertion Force: 1.15N max per contact pair.  
 Withdrawal Force: 0.15N min per contact pair.  
 Contact Retention Force: 3.43N min per contact.  
 Durability: 50 cycles.

**\*Electrical Specification**

Current Rating: 1.1 Ampere.  
 Contact Resistance: 30 mΩ Max.  
 Insulation Resistance: 1000 MΩ Min.  
 Dielectric Withstanding Voltage: 500 VAC.

**\*Environmental**

Operating Temperature: -55°C To +105°C.

**\*How to order:**

WPEW-XXXAK1C41HWZ  
 Series NO. \_\_\_\_\_  
 Number Of Contact \_\_\_\_\_  
 036: (36P)    064: (64P)  
 098: 98P    164: 164P  
 Au A: 1u" D: 15u" F: 30u"  
 K: PA10T  
 1: Black  
 C: Copper Alloy  
 7: Tray+Cap  
 W: Winning Mark  
 N: No Mark  
 H: Halogen Free+RoHS-Compliance  
 1: Straight Metal Posts  
 4: Straddle Type(1.6)

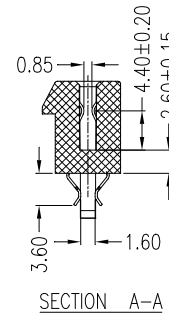
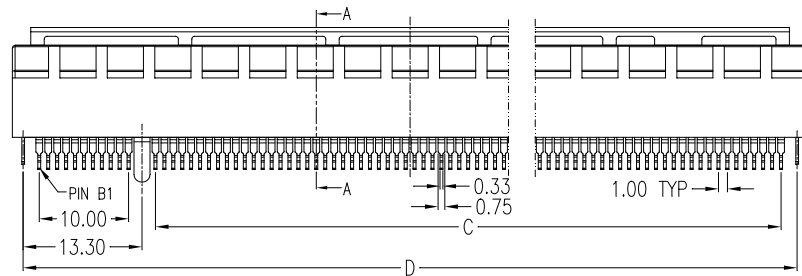
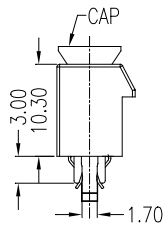
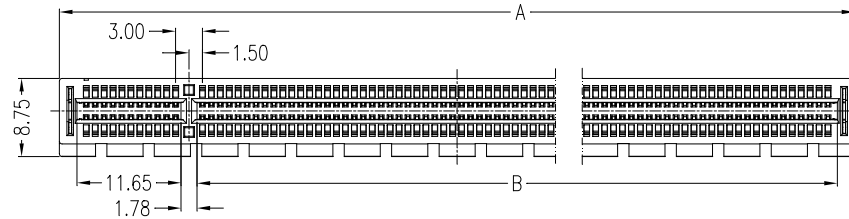
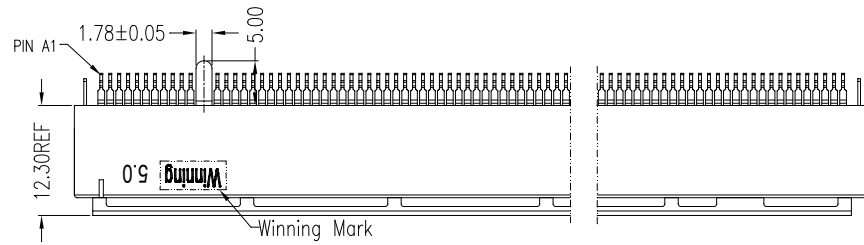

#POS RFE	DIM'A'	DIM'B'	DIM'C'	DIM'D'	DIM'E'
(36P)	25.00	7.65	6.00	22.60	8.15
(64P)	39.00	21.65	20.00	36.60	22.15
98P	56.00	38.65	37.00	53.60	39.15
164P	89.00	71.65	70.00	86.60	72.15

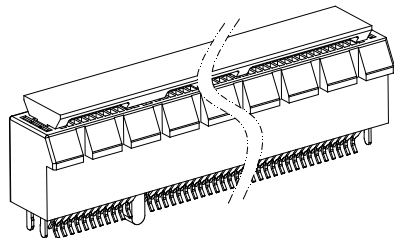

REV Modify Harpoon			Drawing By		Date	WIN WIN PRECISION IND. CO., LTD.		
Units	mm	Scale	1.5:1	LZX	04/07-'24	TEL: 886-2-22994155 FAX: 886-2-22994157		
Tolerance Unless Otherwise Specified			Reviewed By	Charles	Date	04/07-'24	Title	
.X	~	±0.35	Approval By		Nancy	Date	04/11-'24	PCI Express 5.0 Straddle Type (Straight Metal Posts)
.XX	~	±0.25	Drawing No.		WPEW-XXXPS-AN-W248	Sheet	1 of 2	REV
.XXX	~	±0.15	Third Angle Projection					C
Angle	~	± 3°						

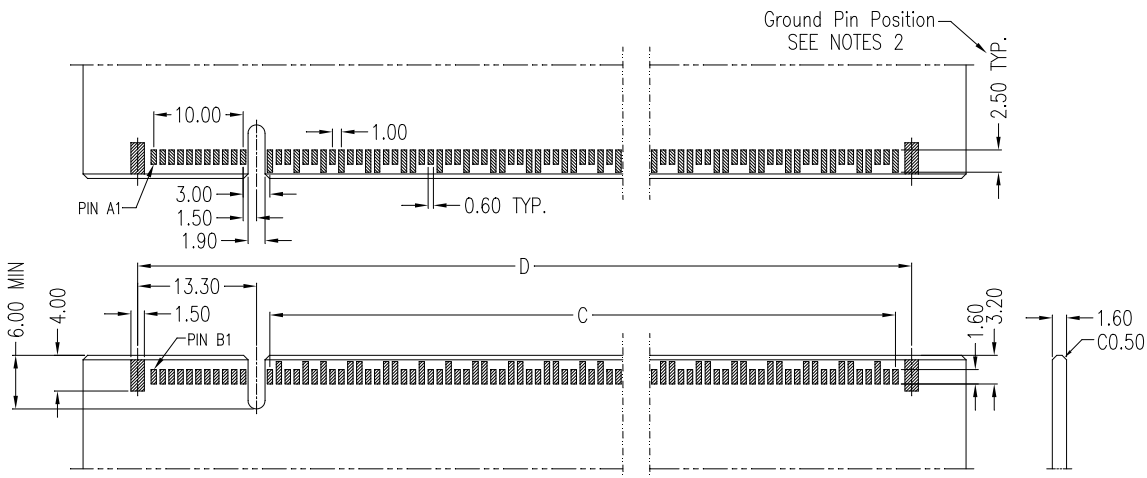

**NOTES 2(Ground Pin Position):**

- 36P: A12, A15, A18, B13, B16, B18,
- 64P: A12, A15, A18, A20, A23, A24, A27, A28, A31, B13, B16, B18, B21, B22, B25, B26, B29, B32,
- 98P: A12, A15, A18, A20, A23, A24, A27, A28, A31, A34, A37, A38, A41, A42, A45, A46, A49, B13, B16, B18, B21, B22, B25, B26, B29, B32, B35, B36, B39, B40, B43, B44, B47, B49,
- 164P: A12, A15, A18, A20, A23, A24, A27, A28, A31, A34, A37, A38, A41, A42, A45, A46, A49, A51, A54, A55, A58, A59, A62, A63, A66, A67, A70, A71, A74, A75, A78, A79, A82, B13, B16, B18, B21, B22, B25, B26, B29, B32, B35, B36, B39, B40, B43, B44, B47, B49, B52, B53, B56, B57, B60, B61, B64, B65, B68, B69, B72, B73, B76, B77, B80.

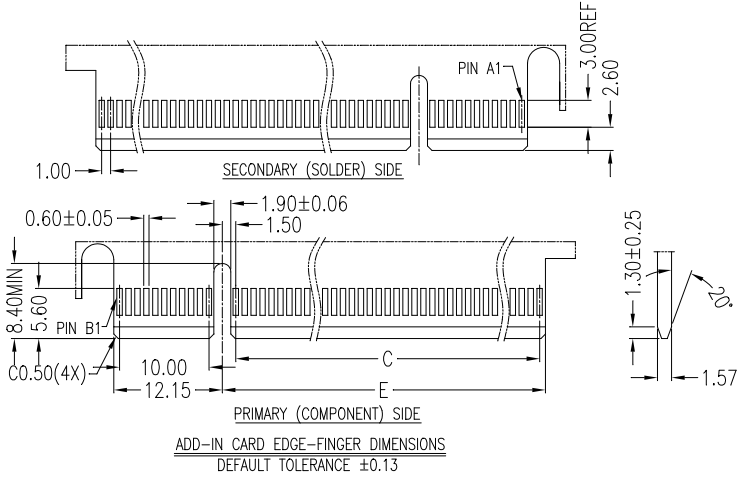

ADD-IN CARD EDGE-FINGER DIMENSIONS  
DEFAULT TOLERANCE ±0.13

**PCI Express Connectors Pinout**

Shorting

Side A	Pin #	Side B
Signal	1	Power
Power	2	Power
Power	3	Power
Ground	4	Ground
Signal	5	Signal
Signal	6	Signal
Signal	7	Ground
Signal	8	Power
Power	9	Signal
Power	10	Power
Signal	11	Signal
Ground	12	Signal
Signal	13	Ground
Signal	14	Signal
Ground	15	Signal
Signal	16	Ground
Signal	17	Signal
Ground	18	Ground
Signal	19	Signal
Ground	20	Signal
Signal	21	Ground
Signal	22	Ground
Ground	23	Signal
Ground	24	Signal
Signal	25	Ground
Signal	26	Ground
Ground	27	Signal
Signal	29	Ground
Signal	30	Signal
Ground	31	Signal
Signal	32	Ground
Signal	33	Signal
Ground	34	Signal
Signal	35	Ground
Signal	36	Ground
Ground	37	Signal
Ground	38	Signal
Signal	39	Ground
Signal	40	Ground
Ground	41	Signal

REV.	ECN.NO.	DATE
A	RELEASED	03/13-'23
B	Modify View	07/25-'23
C	Modify Harpoon	04/07-'24

Side A	Pin #	Side B
Ground	42	Signal
Signal	43	Ground
Signal	44	Ground
Ground	45	Signal
Ground	46	Signal
Signal	47	Ground
Signal	48	Signal
Ground	49	Ground
Signal	50	Signal
Ground	51	Signal
Signal	52	Ground
Signal	53	Ground
Ground	54	Signal
Ground	55	Signal
Signal	56	Ground
Signal	57	Ground
Ground	58	Signal
Ground	59	Signal
Signal	60	Ground
Signal	61	Ground
Ground	62	Signal
Ground	63	Signal
Signal	64	Ground
Ground	65	Ground
Ground	66	Signal
Ground	67	Signal
Signal	68	Ground
Ground	69	Ground
Ground	70	Signal
Ground	71	Signal
Signal	72	Ground
Signal	73	Ground
Ground	74	Signal
Ground	75	Signal
Signal	76	Ground
Signal	77	Ground
Ground	78	Signal
Ground	79	Signal
Signal	80	Ground
Signal	81	Signal
Ground	82	Signal

Shorting

REV Modify Harpoon				Drawing By		Date		WIN WIN PRECISION IND. CO., LTD. TEL: 886-2-22994155 FAX: 886-2-22994157					
Units	mm	Scale	1.5:1	LZX		04/07-'24							
Tolerance Unless Otherwise Specified				Reviewed By		Date		Date	04/07-'24				
.X ~ ±0.35				Charles		04/07-'24		Sheet	2 of 2				
.XX ~ ±0.25				Approval By		Date		Third Angle Projection		Title			
.XXX ~ ±0.15				Nancy		04/11-'24		PCI Express 5.0 Straddle Type (Straight Metal Posts)					
Angle ~ ± 3°										Drawing No.	WPEW-XXXPS-AN-W248	REV	C