

REV.	ECN.NO.	DATE
A	RELEASED	02/11-'11
G	Modify NOTES	11/27-'18
H	Modify Title	05/19-'20

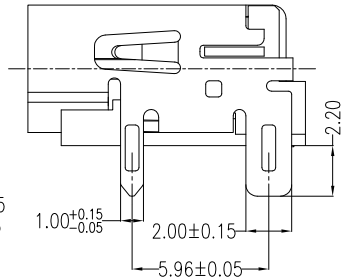
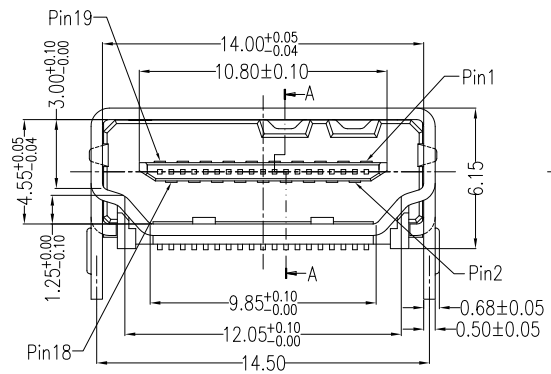

No.	Signal Name	No.	Signal Name
1	TMDS Data2+	11	TMDS Clock Shield
2	TMDS Data2 Shield	12	TMDS Clock-
3	TMDS Data2-	13	CEC
4	TMDS Data1+	14	Reserved (in cable but N.C. on device)
5	TMDS Data1 Shield	15	SCL
6	TMDS Data1-	16	SDA
7	TMDS Data0+	17	DDC/CEC Ground
8	TMDS Data0 Shield	18	+5V Power
9	TMDS Data0-	19	Hot Plug Detect
10	TMDS Clock+		

**NOTES:**

**\*Material**

Housing: LCP, UL 94V-0 Rated; Color: Black.  
 Shell: Brass.  
 Plating: Ni(40u" Min.) Plating .  
 Contact: Brass.  
 Plating: Au plating on contact area;  
 Sn(100u" Min.) plating on solder tail;  
 Ni(50u" Min.) underplating overall.

**\*Electrical Specification**

Operation Voltage: 40 VAC Max.  
 Current Rating: 0.5 Ampere per contact  
 Contact Resistance: 10 mΩ Max.  
 Insulation Resistance: 100 MΩ Min.  
 Dielectric Withstanding Voltage: 500 VAC

**\*Environmental**

Operating Temperature: -55°C to +85°C

**\*How To Order**

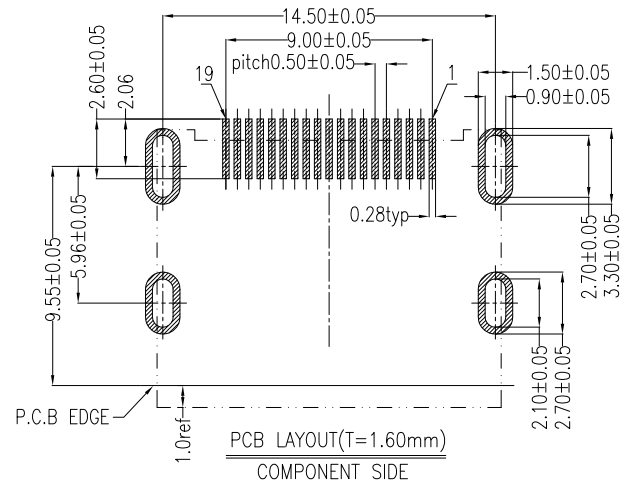
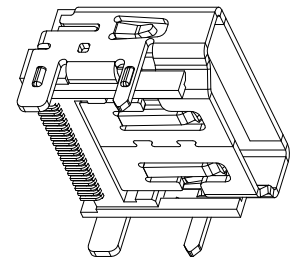
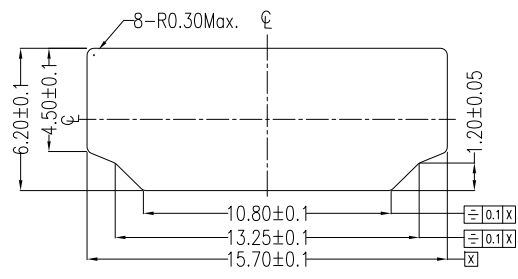
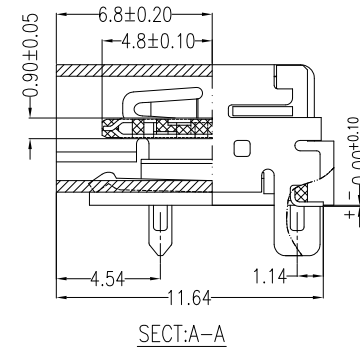
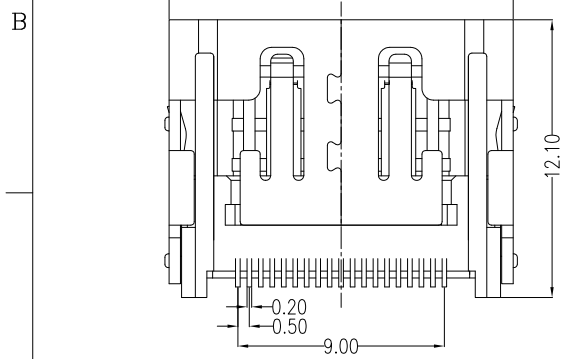
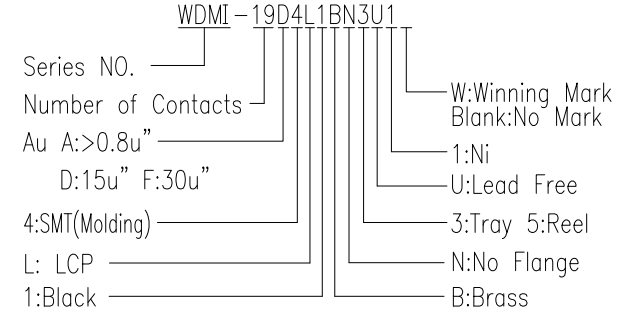

REV		Modify Title: No Posts → No Flange		Drawing By		Date		WIN WIN PRECISION IND. CO., LTD.	
Units	mm	Scale	3:1	WWY	05/19-'20	WINNING		TEL: 886-2-22994155	FAX: 886-2-22994157
Tolerance Unless Otherwise Specified				Reviewed By	Date	Date	05/19-'20	High Definition Media Interface	
.X ±0.35				LDF	05/20-'20	Sheet	1 of 1	19Pin SMT Type(No Flange) (Molding)	
.XX ±0.25				Approval By	Date	Third Angle Projection		Title	
.XXX ±0.15				Nancy	05/21-'20	Drawing No.		WDMI-19PS-AN-N78	REV
Angle ± 3°								H	