

REV.	ECN.NO.	DATE
A	RELEASED	04/18-'22
B	1.Add adsorption cover 2.Modify Notes 3.Modify shrink hole structure	08/29-'22

A

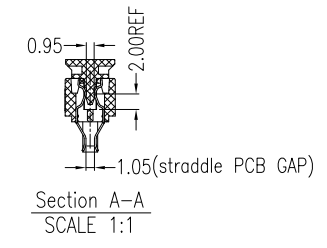

B

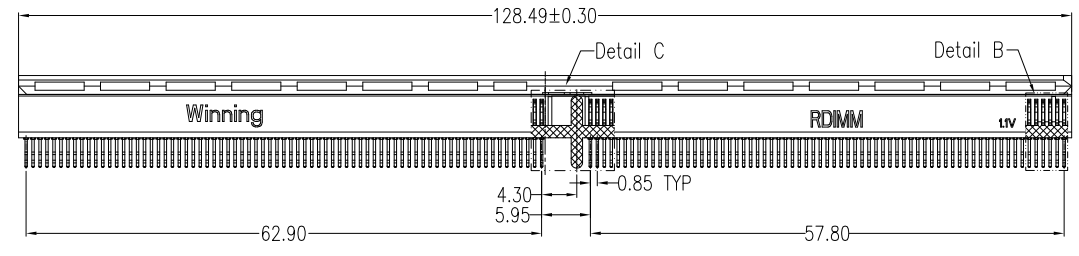
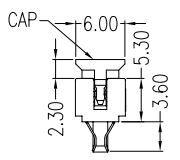
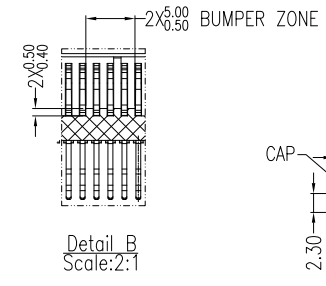
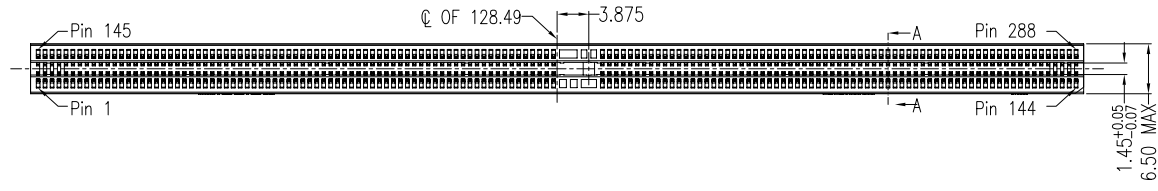
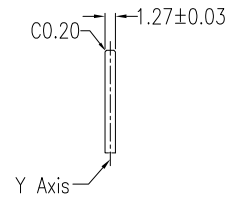
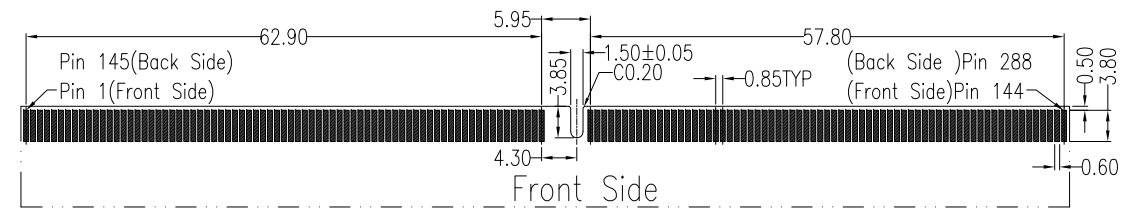
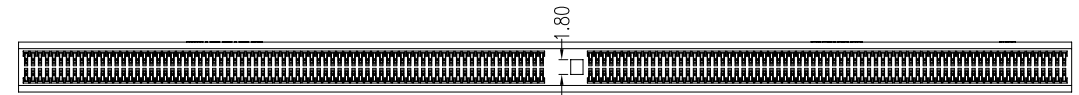
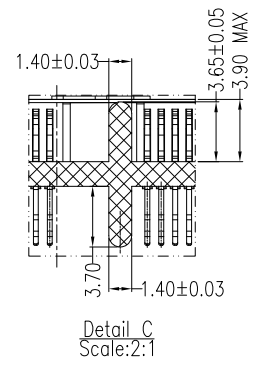

Recommended PCB Layout Thickness=1.27mm Tolerance:±0.03
Both Front and Back Side PADS are Mirror Relation Related to Y Axis
GENERAL TOLERANCE±0.05

C

D

REV	1.Add adsorption cover; 2.Modify Notes; 3.Modify shrink hole structure;			Drawing By	Date	WIN WIN PRECISION IND. CO., LTD.			
Units	mm	Scale	1:1	ZYM	08/29-'22	TEL: 886-2-22994155 FAX: 886-2-22994157			
Tolerance Unless Otherwise Specified				Reviewed By	Date	Date	08/29-'22	Title	
.X	~	±0.35	Charles	08/30-'22	Sheet	1 of 2			
.XX	~	±0.25	Approval By	Date	Third Angle Projection				
.XXX	~	±0.15	Nancy	09/06-'22					
Angle	~	± 3°				Drawing No.	WDD5S-288PS-AN-W122	REV	B

REV.	ECN.NO.	DATE
A	RELEASED	04/18-'22
B	1.Add adsorption cover 2.Modify Notes 3.Modify shrink hole structure	08/29-'22

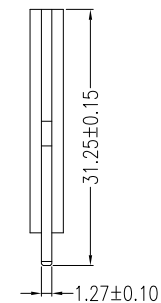
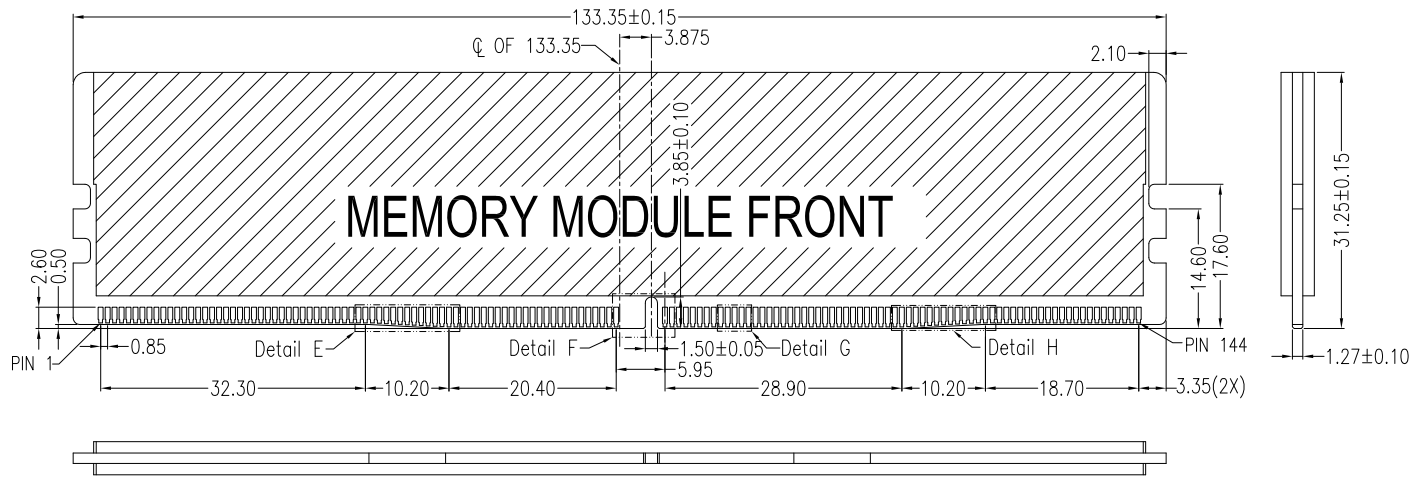

MEMORY MODULE FRONT

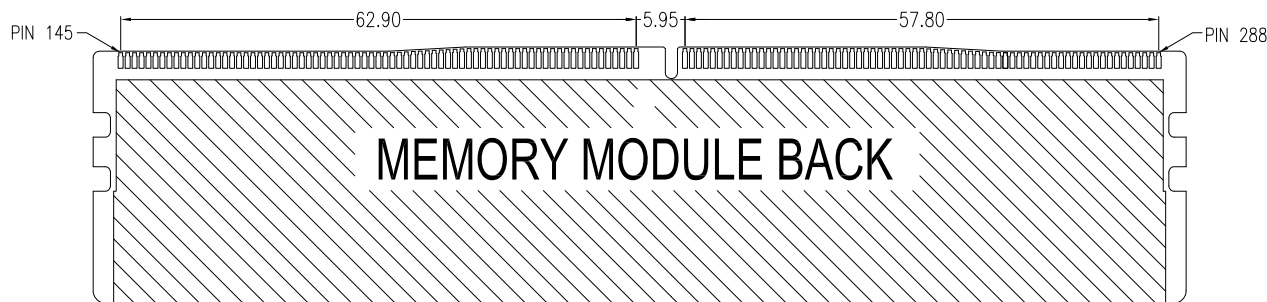

MEMORY MODULE BACK

Recommended Module Layout

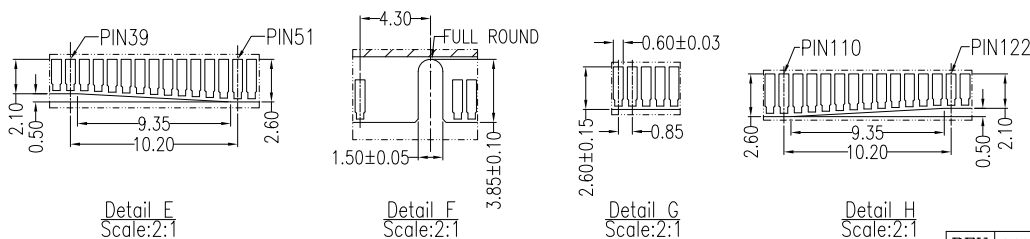

NOTES

*Material

Body: LCP, UL 94V-0.
Contact: Copper alloy.
Plating: Au Plating on contact area.
Sn(100u"Min) plating on solder Tail.
Ni(50u"Min) contact underplating overall.

Contact Retention Force: 300 Grams Min. Per Pin.
Insertion Force: 106.8N Max.
Unmating Force: 19.77N Min.
Durability: 25 cycles.

*Electrical Specification

Contact Resistance: 40mΩ Max Initial ,Change from initial 20mΩ Max.
Insulation Resistance: Apply 500V DC 1MΩ Min. .
Withstand Voltage: 500V AC.

*Environmental

Solderability: Compliance with JESD22-B102;Condition C.
Vibration Unpackaged: Compliance with EIA-364-28.
Cyclic Temperature and Humidity: Compliance with EIA-364-31B.
Thermal shock: Compliance with EIA-364-32.
Operating Temperature: -40°C TO +85°C.
Shock Unpackaged: Compliance with EIA-364-27.

*How To Order

WDD5S-288A5L1PHW3

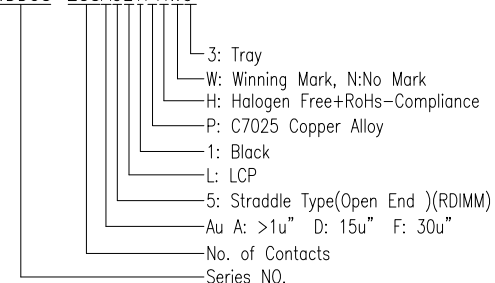

REV	1.Add adsorption cover; 2.Modify Notes; 3.Modify shrink hole structure;			Drawing By	Date	WIN WIN PRECISION IND. CO., LTD.	
Units	mm	Scale	1:1	ZYM	08/29-'22	TEL: 866-2-22994155 FAX: 866-2-22994157	
Tolerance Unless Otherwise Specified				Reviewed By	Date	Date	Title
.X	~	±0.35	Charles	08/30-'22	08/29-'22	DDR5-288P 0.85mm Pitch Straddle Type (Open End Type)(RDIMM/LRDIMM)	
.XX	~	±0.25	Approval By	Date	Sheet		2 of 2
.XXX	~	±0.15	Nancy	09/06-'22	Third Angle Projection		Drawing No. WDD5S-288PS-AN-W122
Angle	~	± 3°					REV B