

REV.	DESCRIPTION	DATE
A	RELEASED	06/22/05
B	Add Lead Free	04/27/05
C	Modify the description	11/21-'22

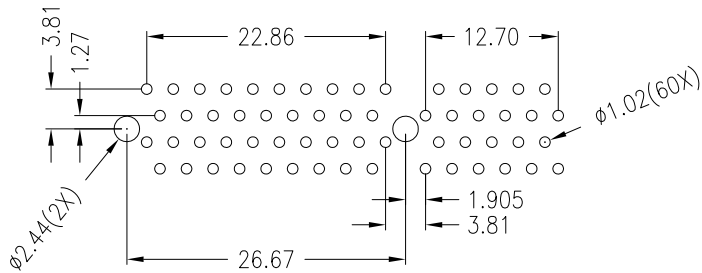

P.C.B. Layout (± 0.05)

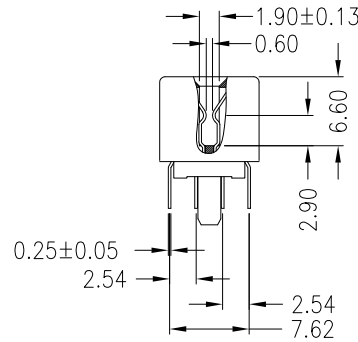
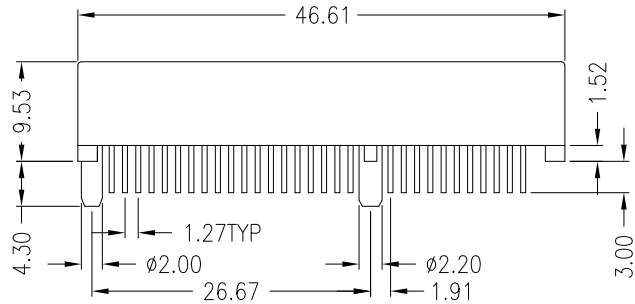
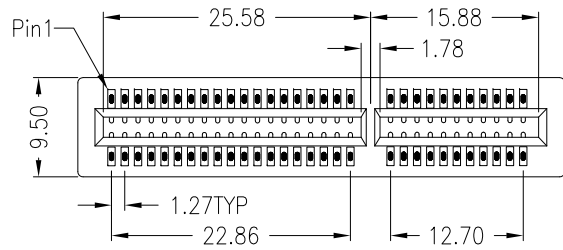
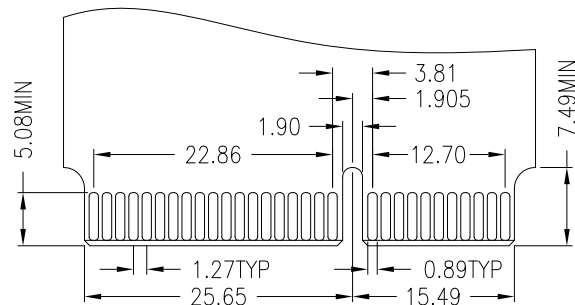

Daughter Card Requirements (± 0.05)

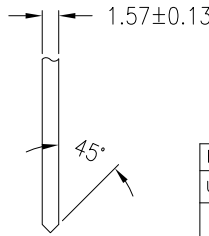

NOTES:

*Material

Body: PPS, UL 94V-0.
 Contacts: Phosphor Bronze.
 Plating: Au Plating On Contact Area.
 Sn(100u" Min.) Plating On Solder Tail.
 Ni(40u" Min.) Underplating Overall.

*Mechanical

Insertion Force: 196 Grams Max.
 Withdrawal Force: 42 Grams Min.
 Contact Retention: 1 lb. min.
 Durability: 50 Cycles.

*Electrical Specification

Current Rating: 0.5 Ampere.
 Contact Resistance: 30 Milliohms Max.
 Insulation Resistance: 1000 Megohms Min.
 Dielectric Withstanding Voltage: 500 VAC.

*Environmental

Operating Temperature: -55°C To +105°C.

*How To Order

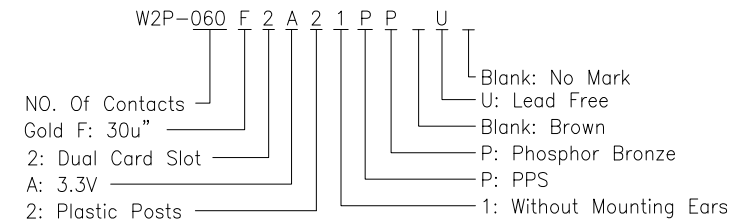

REV	Modify the description			Drawing By	Date	WIN WIN PRECISION IND. CO., LTD.				
Units	mm	Scale	1:1	Rainy	11/21-'22	TEL:886-2-22994155 FAX:886-2-22994157				
Tolerance Unless Otherwise Specified				Reviewed By	Date	Date	11/21-'22	Title	Low Profile 60Pins (Plastic Posts)	
.X	~	±0.35		Rosh	12/02-'22	Sheet	1 of 1			
.XX	~	±0.25		Approval By	Date	Third Angle Projection		Drawing No.	W2P-06XPS-AN-N056	
.XXX	~	±0.15		Nancy	12/06-'22	REV				C
Angle	~	± 3'								